



**Stantec Consulting Ltd.**  
130-2886 Sunridge Way NE, Calgary, AB T1Y 7H9

December 01, 2015  
File: 124910481.300

**Attention: Scott Stevenson**  
Project Manager  
Waterton Lakes National Park  
Box 200  
Waterton Park, AB, ToK 2Mo

Dear Mr. Stevenson,

**Reference: Archaeological Impact Assessment for the Proposed Historic Machine Shed Foundation Replacement at the Bar U Ranch NHS; Contract No. 5P420-15-5143**

At the request of Parks Canada, Stantec archaeologists conducted an Archaeological Impact Assessment (AIA) within prescribed areas around both the existing and proposed footings of the Machine Shed in the Bar U Ranch National Historic Site (NHS) (the Project). The Project is located in the southwest corner of the NHS, south of Pekisko Creek, and immediately south of the Saddle Horse and Work Horse barns; a gravelled access trail runs east-west between the horse barns and the Machine Shed. No archaeological subsurface investigations have been previously conducted in association with the Machine Shed.

At least 35 historic buildings and structures remain extant across the Bar U Ranch property and a rich documentary and photographic history of the Ranch has been maintained since the 1880s. The Machine Shed is a Level 1 resource with a high heritage significance and a high potential to yield significant artifacts and features. Additionally, and as stated in the Archaeological Overview Assessment and Assessment for Historic Machine Shed foundation Replacement, Bar U Ranch NHS (June 2015), prepared by Bill Perry, Terrestrial Archaeologist, Heritage Conservation and Commemoration Directorate, similar assessments at the nearby Saddle Horse and Work Horse barns produced a wealth of information and artifacts.

**Project Background.** Shortly after the Bar U Ranch was purchased by the Canadian Parks Service (ca. 1991), an inventory of sites and features within the ranch property was conducted in order to aid in the development of the site for public interpretation as well as to ensure the protection of cultural resources located within its boundaries (Heitzmann 1993). During the inventory, the Machine Shed was numbered Building or Operation 18, and an estimated history of its life, use, and construction phases were detailed. It is described as a wooden framed building with board and batten siding, oriented west-to-east with a wide gabled roof supported by a single ridge. It was built during George Lane's tenure on the ranch, starting ca. 1910s and measures approximately 65.5 feet (ft.) by 25 ft. (20 m by 7.6 m). There are two sliding doors on the north side of the building, each approximately 10.5 ft. (3.25 m) wide, to gain entry to the long, dirt-floored building. The tall, narrow board and batten addition that now stands at the middle of the



**December 01, 2015**

**Mr. Scott Stevenson**

**Page 2 of 29**

Machine Shed, adjacent and west of the original structure, is oriented with the single ridgeline running south-to-north, has a gable roof, and was likely built on as the steam tractor garage, marking the first indication of mechanization at the ranch (Heitzmann 1993). This addition measures approximately 10.5 ft. by 30 ft. 4 inches (in.) (3.2 m by 9.25 m) and has a swinging set of barn doors across its north face. The final addition to the Machine Shed was installed some time after 1948 to its west side. This board and batten structure has a shed roof that stretches to the ridge line of the steam tractor garage. It measures approximately 22 ft. 4 in. by 30 ft. 4 in. (6.8 m by 9.25 m) and also has swinging barn doors to gain entry. The south wall of this final addition holds the only glass window opening in the structure. The entire building is painted or stained dark red and trimmed with white; the roof is currently covered with asphalt shingles.

The Project will include the raising of the current structure, the installation of cement pads to support internal roof structure support uprights, and the trenching and installation of a new foundation beneath the perimeter wall. The extent of the proposed work is currently unknown, as plans are not yet finalized. The work is scheduled for 2016.

A pre-impact overview assessment was conducted in early June of this year by the project manager, Bar U Ranch management, and Parks Canada terrestrial archaeologists. Recommendations for a targeted pre-impact assessment were made, to comprise the hand excavation of at least six sq m of evaluative shovel tests outside, along the exterior walls as well as an additional four sq m of evaluative tests inside to mitigate the construction of concrete pads that will support the interior uprights (Perry 2015). All tests were to be excavated to non-cultural fluvial gravels and cobbles, or to 1.2 m below grade to accommodate the maximum depth of the concrete pads.

This letter report documents the subsurface (AIA) field assessment component of the current Project. Parks Canada Permit WL-2015-19919 has been issued relative to the Project to encompass the AIA for the proposed development of the proposed Machine Shed foundation replacement in the south portion of the Bar U Ranch NHS.

**Project Location.** The Machine Shed is located at the south edge of the generally level Pekisko Creek floodplain, backing into a sharp rise barely five to seven metres to its south up to a truncated terrace approximately five m above the floodplain (Figure 1; Plate 1). A gravelled road runs along the edge of the terrace in a generally east-west direction, just above the Machine Shed, and a smaller truck trail within the Ranch loops around the horse barns, between them and the Machine Shed, providing access to the Ranch. Poplars, wolf willow, and rare spruce trees grow along the rise, cottonwoods and aspen cover the portion of the floodplain north of the subject building, and dominant vegetation across the subject property includes grass, rose, thistles, yarrow, and other wildflowers. Existing buried facilities, including Telus communication lines, natural gas, and electric cables lie to the north and south of the Machine Shed, but were located and marked prior to the AIA and are located outside the immediate areas targeted for testing.



December 01, 2015

Mr. Scott Stevenson

Page 3 of 29

**Results: Cultural Material.** During the course of the AIA, a total of 40 subsurface shovel tests, or Sub-Operations (each approximately 50 cm by 50 cm square) were excavated by hand at the Machine Shed, yielding a total of 650 pieces of cultural material. Each 50 cm by 50 cm Sub-Op was labelled with an alphabetic letter, starting with 'A' through 'Y' and progressing to 'AA' through 'SS' so as to not duplicate Sub-Op designations; letters 'I', 'O', and 'Z' are not used under this convention. If a Sub-Op was expanded to 100 cm by 50 cm, for example, each was considered a separate Sub-Op and two letters were used (Sub-Ops A and B). Sub-Ops were excavated in 10 cm deep arbitrary, vertical levels or Lots and numbered sequentially, such that Lot 1 is the equivalent to the uppermost 10 cm, Lot 2 equates to 10 cm to 20 cm below surface (B.S.), and so on. All excavated matrices were passed through a ¼" mesh hand screen in order to recover any small pieces of cultural material.

A total of 24 of these tests were excavated around the outside perimeter, along the exterior walls of the Machine Shed (Sub-Ops A to Y and AA), and 16 tests were excavated within the inside of the building (Sub-Ops BB to SS), focused in two areas proposed to have extra roof truss supports installed during the foundation replacement phase of the Project (Table 1; Figures 1 to 3; Plates 2 to 6). Outside tests yielded a total of 350 artifacts and 116 faunal specimens while inside tests yielded a total of 99 artifacts and 85 faunal specimens. All 40 tests were excavated to basal gravels or rocky glaciofluvial deposits, which averaged between 35 cm and 55 cm B.S. outside and 20 cm to 25 cm B.S. inside the structure.

Along the outside walls, the tests revealed a generally thin sod layer overlying a 10 cm thick dark brown silty loam Ah horizon, overlying at least 10 cm of brown sand with increasing gravel, which in turn overlies brown basal gravelly sands and gravels. Inside, the stratigraphy was much simpler, as there was no sod or overlying Ah horizon. Typically, the inside units revealed 15 cm to 18 cm of loose clayey silt transitioning abruptly into coarse gravelly sand, which overlies very rocky gravelly fluvial coarse sands at the base of the excavations. The small block to the east (Sub-Ops BB to JJ) also revealed a red-brown loam with a very high organic content between approximately 12 cm and 24 cm B.S., which could represent decayed sawdust or hay flooring mixed into the substrate.

Of the 24 outside tests, seven were single 50 cm by 50 cm shovel test assessment units (Sub-Op's AA, C, F, R, U, V, and W), four made up one 100 cm by 100 cm assessment unit (Sub-Op's G, H, J, and K), three made up one 50 cm by 150 cm assessment unit (Sub-Op's L, M, and N), and five pairs of tests were opened into 50 cm by 100 cm units (Sub-Op's A and B, D and E, P and Q, S and T, and X and Y) (Figure 2). The inside tests were arranged differently, as these were targeting the subsurface in the areas proposed to be impacted by the construction of the cement pad. To this end, two square metre (2 sq m) contiguous blocks were excavated in each of the two targeted areas inside the original (east wing) structure. One of these resulted in the excavation of a 100 cm by 200 cm block, oriented north-south (Sub-Operations BB to JJ) and located to the east. The other is more centrally located and resulted in an L-shaped contiguous block (Sub-Operations KK to SS) (Figure 2).



**Table 1 Subsurface assessments at the Historic Machine Shed (Operation 18)**

Shovel Test (Sub-Op.)	Location (approx.)	Results	Max. Depth (cm B.S.)	Foundation Exposed
A,B,C,AA, D,E,F,G,J, X,Y	Outside Original Shed	n=274 177 metal, 49 fauna, 26 architectural or building frag's, 15 glass, 6 lithics, 1 piece coal	65	NE, NW, & SW corners - sandstone slab; SE corner - collapsing brick (dry stacked); midway along walls - a combination of sandstone slab or wooden sill plate
H,K,L,M,U, V,W	Outside Tall Tractor Addition	n=120 89 metal, 17 fauna, 6 building frag's, 2 glass, 2 lithics, 2 ceramic, 1 shell button, 1 unknown function	70	NE corner - sandstone slab; NW corner - pounded post; SW corner - 2 ft deep trench filled with gravel; SE - sandstone slab with wooden sill plate
N,P,Q,R, S,T	Outside Final Western Addition	n=70 16 metal, 50 fauna, 2 building or window frag's, 1 lithic, 1 FBR	80	NE, NW, & SW corners - pounded post; SE corner - 2 ft deep trench filled with gravel; no foundation noted beneath window or adjacent to post corners
BB - HH	Inside Original Shed (east)	n=89 24 metal, 51 fauna, 3 building or window frag's, 1 glass (aqua), 1 leather, 9 unknown function	30	No foundations exposed inside structure
JJ - SS	Inside Original Shed (west)	n=95 41 metal (1 coin), 34 fauna, 6 building or window frag's, 5 glass (1 is solarized manganese sherd), 1 leather, 1 lithic, 7 unknown function	35	No foundations exposed inside structure
40 Sub-Ops		449 artifacts, 201 fauna		

Cultural material was recovered from every subsurface test, although outside shovel tests were generally higher yielding than those inside the building. Tests inside yielded an average of 11.5 items per 50 cm by 50 cm test, while tests outside yielded nearly 19.5 artifacts per test (Table 2). The highest frequencies of cultural materials were recovered from the shallowest contexts: inside



the building 74.5% of all artifacts were found between 0 and 10 cm B.S., while tests opened around the outside of the building yielded 71.0% of the assemblage between 0 and 20 cm B.S.

**Table 2 Artifacts recovered from subsurface testing at the Historic Machine Shed (Operation 18)**

Location and Depth of Test	Metal	Fauna	Glass (vessel)	Ceramic	Building or Window (Fragments)	Precontact Lithic	Misc./ Other	Totals
<b>Outside</b>								<b>(466)</b>
Lot 1 (0-10 cm)	140	9	15	3	18	6	1	<b>192</b>
Lot 2 (10-20 cm)	97	30	1	-	12	-	1	<b>141</b>
Lot 3 (20-30 cm)	41	31	-	-	6	1	-	<b>79</b>
Lot 4 (30-40 cm)	4	25	1	-	-	3	-	<b>33</b>
Lot 5 (40-50 cm)	-	13	-	-	-	-	-	<b>13</b>
Lot 6 (50-60 cm)	-	7	-	-	-	-	-	<b>7</b>
Lot 7 (60-70 cm)	-	1	-	-	-	-	-	<b>1</b>
<b>Inside</b>								<b>(184)</b>
Lot 1 (0-10 cm)	64	42	5	-	9	-	17	<b>137</b>
Lot 2 (10-20 cm)	1	37	1	-	-	1	-	<b>40</b>
Lot 3 (20-30 cm)	-	6	-	-	-	-	1	<b>7</b>
<b>Grand Totals</b>	<b>347</b>	<b>201</b>	<b>23</b>	<b>3</b>	<b>45</b>	<b>11</b>	<b>20</b>	<b>650</b>

The large proportion of materials recovered are historic in nature, and most are architectural in function. Metal items (n=347) are predominantly ferrous and include nails, staples, screws, wire, nuts, bolts, washers, cotter pins, a bottle cap, and one Canadian ten-cent silver coin (Table 3). The metal assemblage is dominated by common nails (n=259) and only very few numbers of a great variety of other items. Outside the Machine Shed, common nails make up 83% of the metal; given that most outside tests were against the wall or foundation this is not surprising. Other fasteners and wire are quite evenly split between outside and inside contexts, with fence staples, nuts, and bolts, wire and barbed wire found in both; wood screws and finishing nails were, however, only found outside and an articulated bolt-nut-and-washer assembly and the cotter pins were only recovered from inside the building. A generalized division of metal artifacts based on function can be seen when outside and inside contexts are compared: cans and can lids, bottle caps, reinforcement strapping, a barrel hoop, and a horseshoe nail were only found outside, while clinker, a small spring, and the coin were only found inside. The two contexts (inside and outside) seem to have been used and viewed as quite different spaces during the life history of the Machine Shed. Not surprisingly, artifacts found inside only tend to be more mechanically-oriented, while outside they are broader in function, from architectural to recreational.



**Table 3 Metal artifacts recovered from subsurface testing at the Historic Machine Shed (Operation 18)**

Artifact Type	Outside		Inside				Totals
	Aluminum	Ferrous	Aluminum	Ferrous	Silver	Composite (2 or more metals)	
Barb/ Barbed Wire/ Wire	-	10	-	10	-	-	20
Barrel Hoop	-	1	-	-	-	-	1
Bolt	-	1	-	5	-	-	6
Bolt+Nut+Washers	-	-	-	1	-	-	1
Cans, Lids (Fragments)	-	5	-	-	-	-	5
Clinker	-	-	-	-	-	2	2
Coin	-	-	-	-	1	-	1
Cotter Pin	-	-	-	3	-	-	3
Crown (Bottle) Cap	-	1	-	-	-	-	1
Fence Staple	-	2	-	2	-	-	4
Foil	2	-	2	-	-	-	4
Nail, Common	-	234	-	25	-	-	259
Nail, Finishing	-	2	-	1	-	-	3
Nail, Horseshoe	-	1	-	-	-	-	1
Nut	-	3	-	6	-	-	9
Reinforcing Strap	-	1	-	-	-	-	1
Screw, wood	-	9	-	-	-	-	9
Spring	-	-	-	1	-	-	1
Unidentifiable Scrap/ Miscellaneous	-	9	-	3	-	-	12
Washer	-	1	-	3	-	-	4
<b>Grand Totals</b>	<b>2</b>	<b>280</b>	<b>2</b>	<b>60</b>	<b>1</b>	<b>2</b>	<b>347</b>

Nails were the most frequently recovered artifact at the Machine Shed and, in fact, these ubiquitous items represent 40.5% of the entire assemblage. In outside contexts, the 237 nails make up 50.9% of the recovered materials and 84.0% of the metal while inside, the 26 nails comprise only 14.1% of the recovered materials and 40.0% of the metal. Placement of the outside test units against the walls of the building may have preferentially skewed these results. All but one of the nails are wire drawn, with round heads and round shanks, and 233 of them are considered to be common nails between one and five inches in length. Three fine, short finishing nails and one machine cut horseshoe (or, shoeing) nail complete the assemblage of nails. In both the inside and outside contexts, nails were recovered most abundantly from the uppermost 20 cm B.S., with 191 (or, 80.6%) recovered from Lots 1 and 2 outside, and all 26 (100%) of the inside nails being recovered in the same two Lots (Figures 4 and 5).

Of all the nails, 36 were bent or clenched and their lengths were therefore not calculated, and another 53 of them were incomplete or too corroded to be correctly measured. Considerably more nails were small in size, with 119 being two inches or less in length (45.3%) and no more than



11 nails are four inches or longer (three of the latter are bent and measurements are therefore approximated) (Table 4).

**Table 4** Size and type of nails recovered from subsurface testing at the Historic Machine Shed (Operation 18) at the Bar U Ranch NHS

Nail Type and Size		Outside	Inside	Totals
Nail, Common – complete	1"	62	4	<b>66</b>
	1 1/8"	20	-	<b>20</b>
	1 1/4"	3	4	<b>7</b>
	1 3/4"	3	-	<b>3</b>
	2"	23	-	<b>23</b>
	2 1/2"	12	2	<b>14</b>
	2 3/4"	1	-	<b>1</b>
	3"	20	3	<b>23</b>
	3 1/4"	3	1	<b>4</b>
	3 1/2"	1	-	<b>1</b>
	4"	7 (9?)	-	<b>7</b>
5"	1 (2?)	-	<b>1</b>	
Nail, Common – complete, bent/clenched	-	33 (30?)	3	<b>36</b>
Nail, Common – incomplete/corroded	-	45	8	<b>53</b>
Nail, Finishing	1 3/4"	1	-	<b>1</b>
Nail, Finishing	Bent	1	1	<b>2</b>
Nail, Horseshoe	-	1	-	<b>1</b>
<b>Grand Totals</b>		<b>237</b>	<b>26</b>	<b>263</b>

Faunal items (n=201) include specimens from birds, pig, rodents, *Bison/Bos*, large ungulate, and unidentified mammal, and elements from nearly every body part are also represented (teeth, crania, ribs, long bones, vertebrae, toes, and tarsals) (Table 5). One shell button and a roughly cut piece of leather (both recovered from inside contexts) complete the faunal assemblage but are not included in the following discussion regarding bone and animal use in and around the Historic Machine Shed.

The faunal assemblage is comprised of a combination of mammal and bird remains and both domestic and wild species are represented. Mammals are represented by at least two bison, one pig, one rodent (larger than a ground squirrel), one large ungulate, and one small ungulate (possible sheep/goat). The birds include at least one small, one medium (chicken-sized), and one large bird (Table 6). Faunal remains are split fairly evenly between inside and outside contexts by frequency, with 116 being recovered outside and 85 inside, but by mass, there is close to four times as much recovered from outside contexts (881.4 g outside and 199.8 g recovered inside). More *Bos/Bison*, bird, and rodent remains were recovered outside the building (and including larger fragments thereof) while large and small ungulate remains were relatively evenly split



between inside and outside contexts. Very little of the fauna shows evidence of cultural modification: six large ungulate bones were burned or calcined, one large ungulate long bone fragment has a spiral fracture, and one pig-size phalanx is sawn; half of these were recovered outside (the sawn phalanx, the spiral fractured long bone, and two burned long bone fragments) and half inside (four burned or calcined cranial and long bone fragments). In addition, there are nine bones observed to have been gnawed by a carnivore, all of which were recovered outside.

**Table 5 Faunal remains recovered from subsurface testing at the Historic Machine Shed (Operation 18) at the Bar U Ranch NHS**

Animal Taxon		Outside		Inside	
		Frequency	Mass (g)	Frequency	Mass (g)
<b>Mammalia</b>	<b>Mammals (Total)</b>	<b>108</b>	<b>872.5</b>	<b>80</b>	<b>199.1</b>
Artiodactyla	<i>Bison/Bos</i>	4	443.9	1	21.2
	<i>Sus scrofa</i> (Pig)	1	1.0	-	-
	Ungulate, large (unidentifiable)	89	394.7	75	171.4
	Ungulate, small (unidentifiable)	1	2.3	3	4.7
Rodentia	Rodent (unidentifiable)	2	0.5	1	0.3
	Mammal, large (unidentifiable)	3	27.3	-	-
	Mammal, medium (unidentifiable)	-	-	1	1.1
	Mammal, small-to-medium (unidentifiable)	-	-	1	0.1
	Mammal (unidentifiable)	8	2.8	1	0.3
<b>Aves</b>	<b>Birds (Total)</b>	<b>8</b>	<b>8.9</b>	<b>2</b>	<b>0.7</b>
	Bird, small (unidentifiable)	1	0.2	-	-
	Bird, small to medium (unidentifiable)	1	4.7	-	-
	Bird, medium (unidentifiable)	4	0.5	1	0.2
	Bird, large (unidentifiable)	2	3.5	1	0.5
<b>Grand Totals</b>		<b>116</b>	<b>881.4</b>	<b>85</b>	<b>199.8</b>

Although fauna make up the second largest category of material types recovered during the current Project, there is little in the assemblage to indicate an activity area or pattern of building/land use that might further inform the history of the Machine Shed. Instead, a wide variety of animals seem to have either died here naturally (such as the rodents), been killed and processed elsewhere and, in part, consumed here, or parts thereof were disposed of here for some other reason. Farm dogs and other carnivores seem to have been largely restricted to the outside of the Shed while eating and, similarly, the only butchered bones in the assemblage were recovered from outside tests.





**Table 6 Faunal remains recovered at site 1670R, Operation 18, Historic Machine Shed**

Animal Class / Sub-Op	Bird (size)	Bos/Bison	Mammal (size)	Ungulate (size)	Grand Totals
Outside Sub-Op (Lot 1)	1 carpo-metacarpus (small)	-	1 scrap bone frag. (unknown)	5 long bone frag's, 1 cranial frag., 1 rib fragment (large)	9
Outside Sub-Op (Lot 2)	1 thoracic vertebra frag., 1 long bone frag. (large); 2 lumbar vertebrae, 1 synsacrum, 1 vertebra frag. (medium)	-	1 phalanx (pig); 1 scrap bone frag. (unknown); 1 tooth (large)	11 rib frag's, 6 long bone frag's, 2 cranial frag's, 1 tooth frag., 1 scrap bone frag. (large)	30
Outside Sub-Op (Lot 3)	-	2 incomplete scapulae	1 scrap bone frag. (unknown); 1 tooth (large)	9 scapulae frag's, 8 long bone frag's, 4 scrap bone frag's, 3 rib frag's, 1 astragalus, 1 tooth, 1 cranial frag. (large)	31
Outside Sub-Op (Lot 4)	-	1 internal auditory meatus	1 femur (rodent)	1 thoracic vertebra frag. (small); 16 cranial frag's, 3 scrap bone frag's, 2 long bone frag's, 1 rib frag. (large)	25
Outside Sub-Op (Lot 5)	-	1 first phalanx	1 incomplete tibia (large); 4 scrap bone frag's (unknown)	6 long bone frag's, 1 scrap bone frag. (large)	13
Outside Sub-Op (Lot 6)	1 synsacrum (small-medium)	-	1 scrap bone frag.	3 long bone frag's, 1 rib frag., 1 hyoid frag. (large)	7
Outside Sub-Op (Lot 7)	-	-	1 femur (rodent)	-	1
Inside Sub-Op (Lot 1)	1 vertebra frag. (medium)	-	1 long bone frag. (medium, pig-sized); 1 cranial frag. (small-medium)	1 tooth, 1 vertebra frag. (small); 26 long bone frag's, 7 rib frag's, 2 cranial frag's, 2 scrap bone frag's (large)	42
Inside Sub-Op (Lot 2)	1 rib (large)	1 second phalanx	1 mandible (rodent)	1 vertebra frag. (small); 14 scrap bone frag's, 12 long bone frag's, 7 rib frag's (large)	37
Inside Sub-Op (Lot 3)	-	-	1 scrap bone frag.	1 rib, 4 long bone frag's (large)	6
<b>Grand Totals</b>	<b>10</b>	<b>5</b>	<b>18</b>	<b>168</b>	<b>201</b>



December 01, 2015

Mr. Scott Stevenson

Page 10 of 29

Of much lower frequency than metal and fauna are items made of stone/ceramic masonry/window glass or foundation material (n=45), bottle or container glass (n=23), unidentified/miscellaneous materials (n=16), miscellaneous organic material (n=13), precontact lithics (n=11), miscellaneous inorganic material (n=5), and ceramic earthenware (n=3) were also recovered. Items of particular interest include one sherd of aqua-coloured and one of solarized manganese purple-coloured glass and the Canadian coin. Altogether 29 sherds of glass were recovered during the current program (19 from outside contexts and 10 from inside), representing at least two bottles (one colourless and one amber/brown) and one window pane. Two other glass sherds from unidentifiable vessels or objects were also recovered that may be temporally diagnostic. One sherd of moulded aqua-coloured glass may have been part of a vessel manufactured prior to the 1920s (in the case of a bottle) or the 1930s (in the case of a jar), as aqua-coloured glass was most popular for these vessels during this time period (Society for Historic Archaeology – SHA 2015). Similarly, the piece of solarized manganese glass (artifact 1670R18MM1:5; Plate 21) indicates a pre-WWI date of manufacture for this particular glass vessel, as manganese was no longer used as a decolourizing agent after 1914 (SHA 2015). The coin, a Canadian 10 cent piece (artifact 1670R18PP1:1; Plate 22) was minted in 1919 and the obverse indicates this was during the reign of King George V, reading “GEORGIVS V DEI GRA REX ET IND:IMP”. The reverse shows two maple branches tied in a bow with the regent’s crown poised at the top of the wreath; “10 CENTS/CANADA” and the 1919 mint date fills the space inside the wreath. All three of these early 20<sup>th</sup> century items were recovered from test units inside the Machine Shed, indicating the early date during which the space was frequently used.

A total of ten lithic artifacts and one piece of fire-broken rock (FBR) were also recovered at the Machine Shed. These artifact types, typically considered to be precontact or traditional in use and function, were recovered from contexts mixed with historic materials, between the ground surface and 40 cm B.S. and from tests both inside and outside the building (Table 7). Lithic artifacts include one quartzite biface, one chalcedony retouched flake, four grey undifferentiated coarse-grained material (UCGM) consisting of two secondary flakes and two waste flakes, one brown quartzite secondary flake, and three grey siltstone consisting of one primary and two waste flakes. While it is possible that these artifacts were displaced or mixed with more recent cultural deposits during the construction of the building or other historic ground disturbance activities, these specimens are somewhat randomly situated across the site (along the back south wall of the entire structure and inside the eastern original structure) and do not seem to represent a discrete or separable occupation of the site, either vertically or horizontally. The lithics were recovered between the ground surface and 40 cm B.S. outside, between 10 cm and 20 cm B.S. inside, and the FBR was found quite deep (between 30 cm and 40 cm B.S.) in an outside test beneath the window of the latest west addition.

Of the ten lithic artifacts in the assemblage, one is a grey quartzite biface, one is a brown chalcedony retouched utilized flake, four are flake fragments, three are secondary flakes, and one is a primary decortication flake. Lithic reduction practices represented in this very small assemblage range from early stage cobble reduction to late stage tool manufacture and use.



These may represent the sparse remains of a lithic workshop or a campsite where such artifacts would be typically produced and/or used through the course of a site's occupancy.

**Table 7 FBR and lithic artifacts recovered at the Historic Machine Shed (Operation 18), Bar U Ranch NHS**

Material Type	FBR (fire-reddened)	Waste Flake	Primary Decortication Flake	Secondary Flake	Tool	Total
Chalcedony, brown	-	-	-	-	1	<b>1</b>
Quartzite, brown	-	-	-	1	-	<b>1</b>
Quartzite, grey	-	-	-	-	1	<b>1</b>
Quartzite, grey: reddened	1	n/a	n/a	n/a	n/a	<b>1</b>
Siltstone, grey	-	2	1	-	-	<b>3</b>
UCGM, grey	-	2	-	2	-	<b>4</b>
<b>Grand Totals</b>	<b>1</b>	<b>4</b>	<b>1</b>	<b>3</b>	<b>2</b>	<b>11</b>

Artifact 1670R18E3:1 (Plate 19) is a grey quartzite broken biface recovered from a shovel test (Sub-Op E) mid-way along the back south wall of the original structure, between 20 cm and 30 cm B.S. It is oval in shape. Both left and right lateral edges are convex as are the distal and proximal ends. It is biconvex in tranverse and longitudinal section. It has been bifacially worked on both sides and both ends. Flaking is restricted to the edges on the ventral surface, but extends across the dorsal surface to the midline. At this point, flakes have hinged to form a raised knot of material in the middle of the biface. It is broken in two places: diagonally on the right side at the base, removing a small portion of the base and right lateral edge; and, diagonally on the left lateral edge. This break extends from a point roughly midway along the edge and continues until nearly the tip. The maximum length is 79.15 mm, the maximum width is 53.57 mm and the thickness is 13.56 mm; its mass is 53.6 g.

Artifact 1670R18JJ2:4 (Plate 20) is a retouched brown chalcedony flake fragment; the chalcedony is flecked with dark brown inclusions. The small artifact was recovered from a test inside the original structure (Sub-Op JJ), between 10 cm and 20 cm B.S. The fragment is missing both the platform and the distal end and has been finely and purposefully retouched on both lateral edges. Flakes have been removed bifacially from one lateral edge. The other lateral edge has flakes removed unifacially on the dorsal surface with evidence of utilization on the ventral surface. All flake removal is confined to the margins of the flake. There are no measurements available due to its fragmented condition; its mass is 0.2 g.

**Results: Structural Foundations.** Another objective of the AIA subsurface study at the Machine Shed was to investigate and evaluate the existing foundations that currently support the structure (Figure 5). Given that the Machine Shed was built in three stages over perhaps a 40 year (or more) timespan, it was not unexpected to find that each phase of the building is supported differently,



December 01, 2015

Mr. Scott Stevenson

Page 12 of 29

despite the similar outer façades. Outwardly, the entire building sports a dark red stained board and batten siding, which runs the full height of the wall, from the ground up to the roof rafters or overhanging fascia; trim and fascia boards are painted a contrasting white (Plates 1 and 2).

- Starting with the earliest section (east wing) of the building, the subsurface tests revealed a preference for the use of sandstone slabs as corner supports. The NE, NW, and SW corners as well as one position midway along the 20 m-long south wall each had a minimum of one flat piece of sandstone in position beneath the corner or support post (Plates 3, 4, 7, 12, and 13). The SE corner, however, was supported most recently by dry (un-mortared), stacked bricks that had come loose and sat on the surface, and earlier by stacked, undressed sandstone rocks that seem to have been set in the bottom of a 45 cm deep trench and subsequently backfilled with gravel (Plate 8). It seems feasible that this back corner of the building shifted or dropped and the bricks were used as a stop-gap measure to slow the imminent collapse. Where the sandstone slabs in the other corners are squared or roughly dressed, average six to eight cm thick and at least 35 cm long by approximately 20 cm wide and located within barely 3 cm of the surface, the sandstones in this corner seem not to have been finished and to have been set in a relatively deep hole instead of simply lying on the surface. It is also possible there was a natural depression in this position that was simply filled with gravel, levelling off the grade, and the sandstones were placed strategically within the depression prior to the erection of the superstructure.
  - Architectural artifacts were recovered from tests in and around this earliest Machine Shed structure. Outside tests yielded 32 such artifacts, consisting of three brick fragments, one piece of mortar, one small chunk of red paint, six pieces of finished wood, painted red, and 21 small pieces of masonry stone (16 sandstone, four coarse-grained material, and one quartzite). Inside tests yielded a further five architectural items: two pieces of mortar and three pieces of finished/milled wood with saw marks were recovered from inside the original structure.
- Subsurface tests around the corners of the central tall steam tractor garage addition revealed an inconsistent foundation plan. Three tests along its eastern wall (at the NE and SE corners and at the join between its east wall and the NW corner of the original structure) revealed either sandstone slabs or a combination of sandstone slab supporting a wooden sill plate (Plates 7, 8, and 12). The sill plate supporting the SE corner of the addition is fully rotted and barely distinguishable. Tests at the SW corner revealed only 60 cm (2 ft.) of gravel fill with no stone, brick, or additional wooden support beneath the corner (Plate 8). This may represent a similar strategy to that seen above, where a natural depression was filled with gravel to level off the grade prior to construction. The test at the NW corner revealed a pounded post, similar to those used in the west corners of the west addition. It seems likely that whatever foundation or corner support was used during the initial construction was replaced with a pounded post when the final west wing addition was constructed.



December 01, 2015

Mr. Scott Stevenson

Page 13 of 29

- Architectural artifacts were also recovered from tests outside this steam tractor addition to the Machine Shed. Three shovel tests yielded six such artifacts, consisting of five small pieces of masonry stone (all sandstone) and one piece of finished wood with nail holes.
- The subsurface tests around the corners of the west wing addition revealed deeply pounded posts at the NE, NW, and SW positions. Each of these is between approximately 15 cm and 25 cm in diameter and have been pounded at least 60 cm (2 ft.) into the ground. For safety and building integrity purposes, none of these posts was fully exposed, and the bottom of each was never reached (Plates 9 to 11). The supposition that these posts were pounded into place arose due to the observed lack of fill, disturbed sediments, or previously excavated post hole adjacent to these three corner posts. The tests at the SE corner of this west addition revealed only 60 cm (2 ft.) of gravel fill with no post, stone, brick, or additional wooden support beneath the corner. As above, and seen with the original structure, gravel fill may have been used strategically in this position; *i.e.*, a natural depression may have been filled with gravel to level off the grade prior to construction. It is unclear from the AIA tests whether this strategy was attempted during the construction of the steam tractor or west wing addition, or perhaps at some other time altogether.
- One architectural artifact was recovered from tests outside this latest addition to the Machine Shed. One small piece of mortar was recovered from shallow contexts in a test located at the SE corner of the addition.

In general, the tests on the outside and along the east, south, and west sides were relatively deep, while those inside and along the north wall of the Machine Shed were considerably shallower. It is expected that colluvial deposition combined with slumping from the steep wall and terrace above have contributed to the sedimentation and soil development that is slowly burying the rear of the building. Ancient, buried fluvial deposits were observed at the base of all shovel tests, and damp to wet sediments were encountered in the large, expanded test (100 cm by 100 cm) at the join between the original structure and the tall steam tractor garage (along the south wall), suggesting fluvial activity continues to influence the integrity of the strata at this location. Today, the Machine Shed is located approximately 100 m south of Pekisko Creek, but the course of this meandering stream has and will continue to shift across its wide floodplain. Shovel tests ranged between 30 cm and 70 cm B.S., and reached at least 5 cm into basal glaciofluvial deposits.

The AIA was quite productive at the Machine Shed. Cultural material was recovered from each of the 40 shovel tests opened around and inside the building. A total of 449 artifacts and 201 faunal specimens were recovered from the subsurface testing, and structural foundation information relative to the three phases of building construction was identified. Notwithstanding the positive results from the current study, any cultural resources identified during the ground disturbance associated with the Machine Shed Foundation Replacement should be recorded and reported to a Parks Canada archaeologist. This construction should also be coordinated with and monitored by an archaeologist. Minimally, the location of any find should be recorded with a GPS device,



**December 01, 2015**  
**Mr. Scott Stevenson**  
**Page 14 of 29**

and photographs taken. The archaeologist will discuss and take any required protective or mitigative actions that might be needed.

Based on the results of the current AIA as detailed in this report, and given the outstanding monitoring requirements during construction, Stantec recommends that there are no additional archaeological concerns with the planned redevelopment of the Historic Machine Shed at the Bar U Ranch NHS. The results and recommendations of this assessment should be confirmed by Parks Canada terrestrial archaeologists.

Sincerely,

**STANTEC CONSULTING LTD.**

Dale E. Boland, M.A.  
Senior Archaeologist  
Phone: 403-806-1311  
Fax: 403-244-4701  
[Dale.Boland@Stantec.com](mailto:Dale.Boland@Stantec.com)

cc. E. Gwyn Langemann, M.A.,  
Bill Perry, M.A.

*Attachment: Figures 1 to 5; Plates 1 to 22; Catalogue Sheets*

#### References Cited

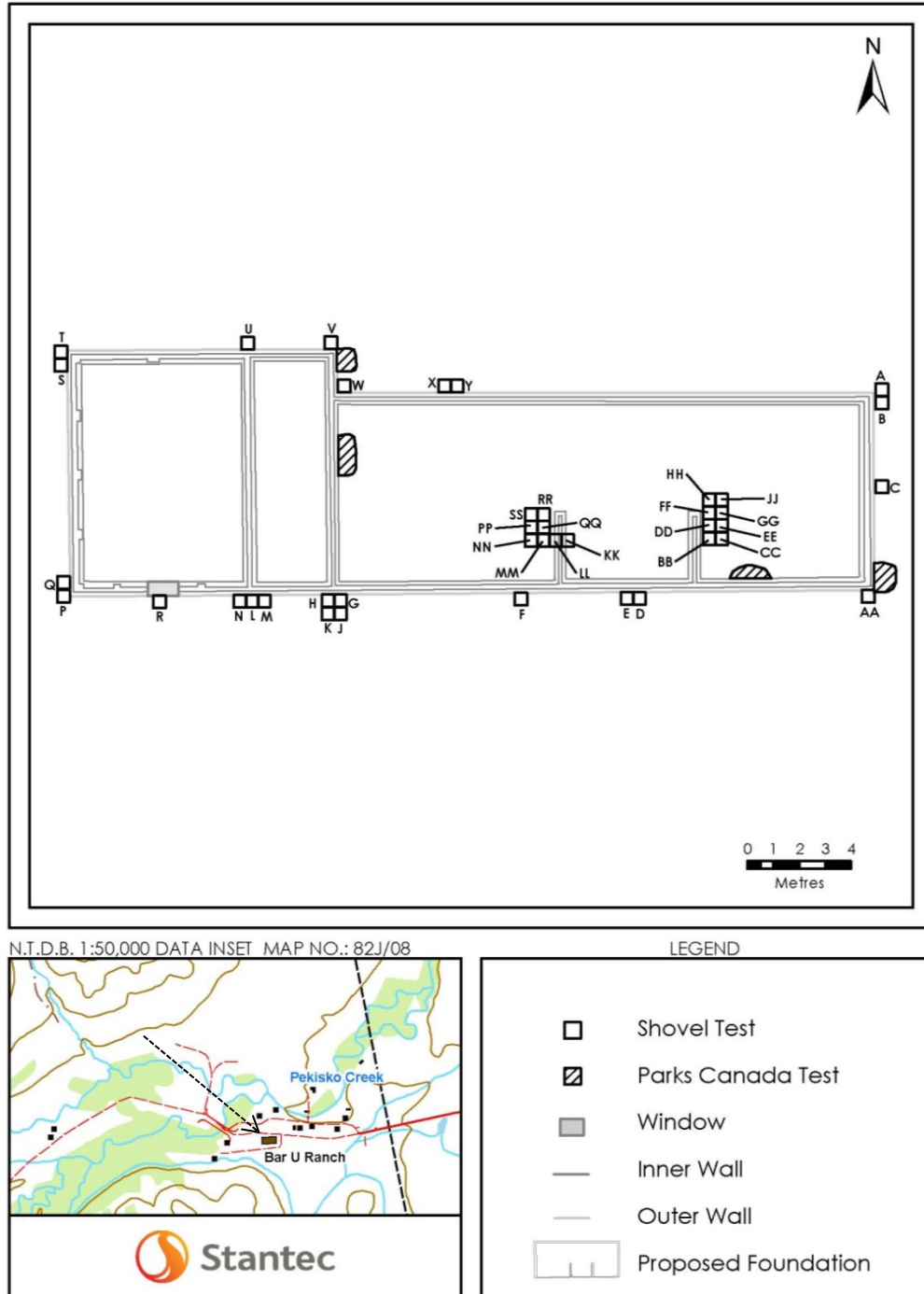
- Heitzmann, R.J. 1993. *Bar U Ranch National Historic Site Preliminary Archaeological Inventory and Assessment*. Unpublished document available at Parks Canada Agency Western Service Centre, Calgary, Alberta.
- Perry, B. 2015. *Archaeological Overview Assessment, Assessment for location of New Workshop, Bar U Ranch NHS. Annex A – Statement of Work*. Parks Canada Agency, Calgary, Alberta. Document prepared June 2015.
- Society for Historic Archaeology (SHA). 2015. *Historic Glass Bottle Identification & Information Website; Bottle/Glass Colors*. Website co-published with the Bureau of Land Management (BLM) and maintained by Bill Lindsey. Available online at <http://www.sha.org/bottle/colors.htm> Website accessed on 16 November, 2015.



December 01, 2015  
 Mr. Scott Stevenson  
 Page 15 of 29

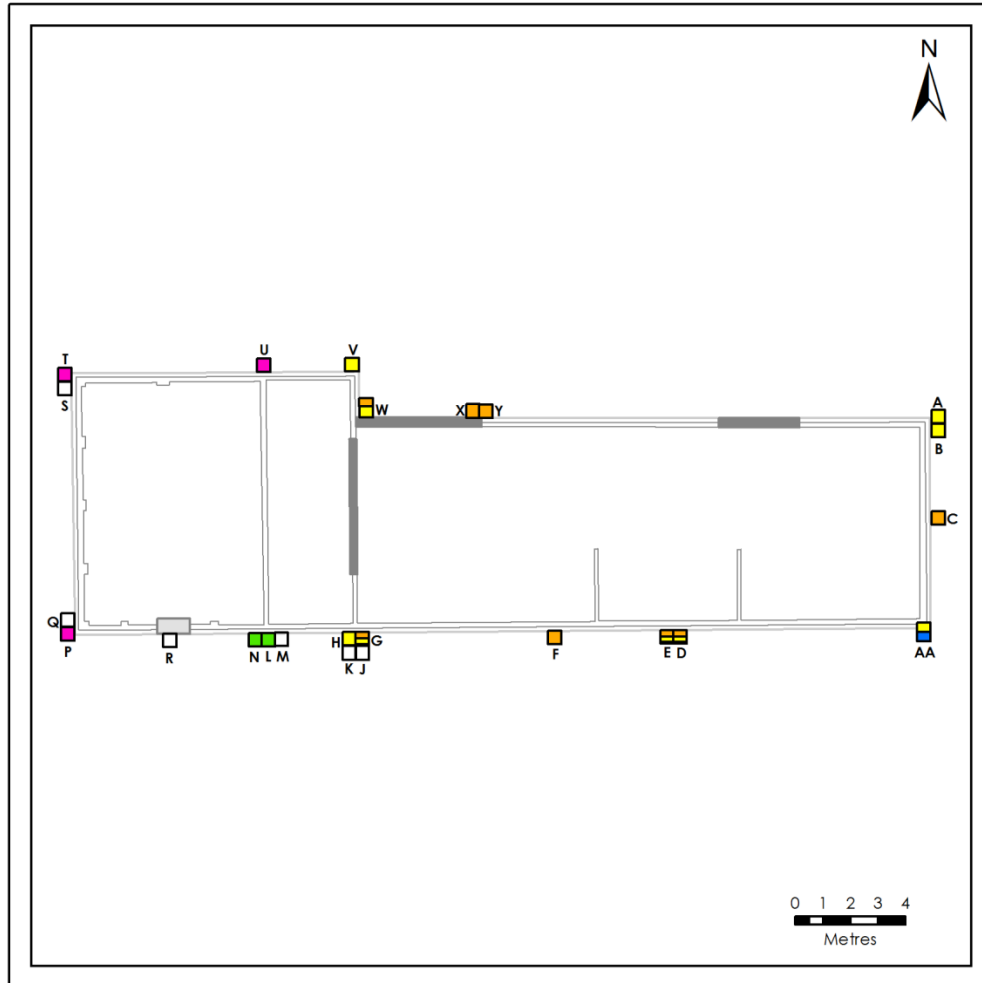


**Figure 1** Orthophoto image of the Bar U Ranch NHS (southern portion) showing subsurface test locations within Machine Shed (Operation 18) Project Area

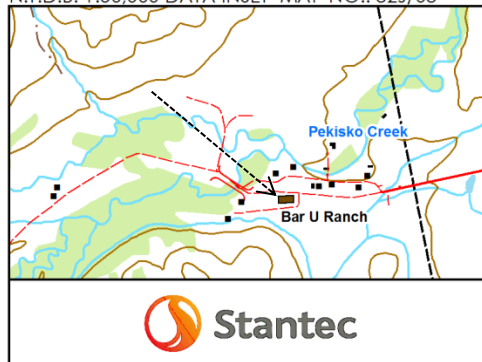


**Figure 2** Historic Machine Shed test area (Operation 18) and locations of shovel test assessments





N.T.D.B. 1:50,000 DATA INSET MAP NO.: 82J/08



LEGEND

	No Foundation Evidenced
	Pounded Post Foundation
	Sandstone Slab Foundation
	Brick Foundation
	Sill Plate (Wood) Foundation
	Gravel Fill Foundation
	Sandstone Slab/ Sill Plate Foundation
	Window
	Sliding Door
	Inner Wall
	Outer Wall

Figure 3 Historic Machine Shed subsurface tests (Operation 18) and results of existing foundation assessment

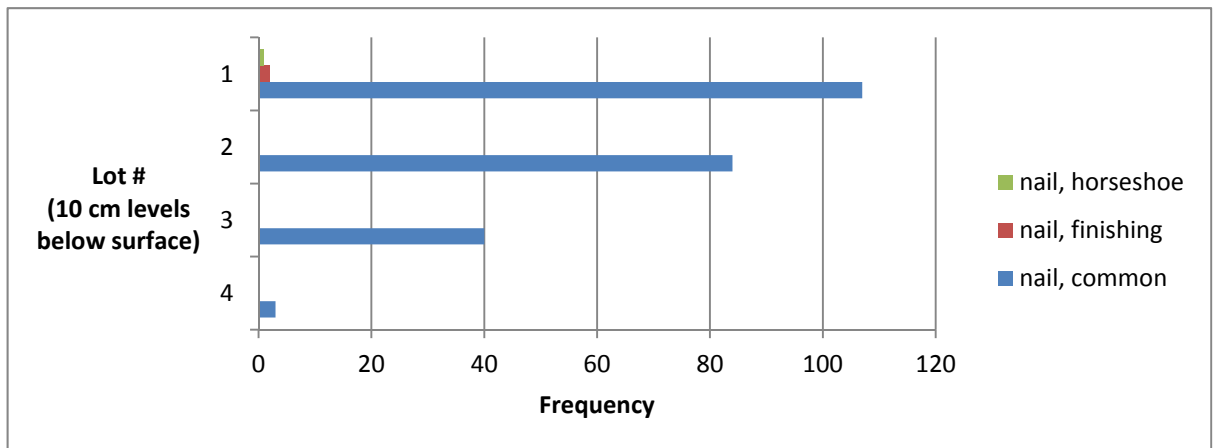


Figure 4 Chart showing frequency of nails by depth of recovery in contexts outside the Historic Machine Shed, Bar U Ranch NHS

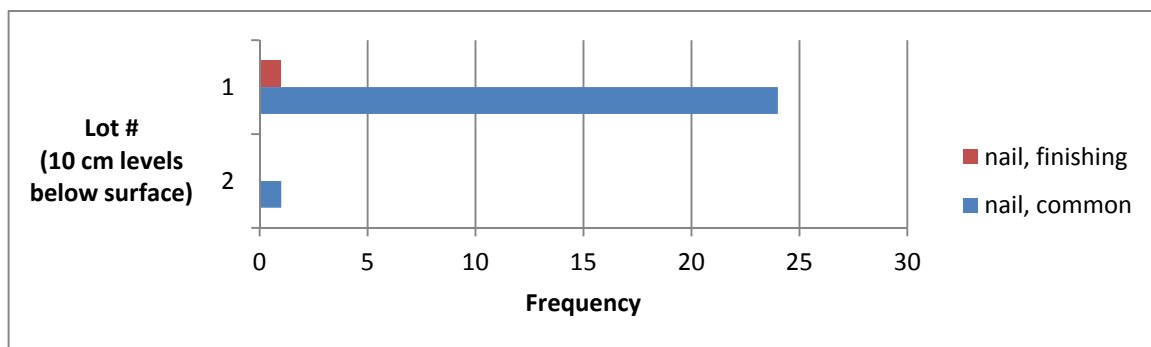


Figure 5 Chart showing frequency of nails by depth of recovery in contexts inside the Historic Machine Shed, Bar U Ranch NHS



**Plate 1** Northeast view of south and west façades of Historic Machine Shed; note differing rooflines indicating successive phases of building construction



**Plate 2** Northeast view of completed and backfilled shovel tests along outside south wall of Historic Machine Shed



**Plate 3** West view of 50 cm deep shovel tests (Sub-Ops A and B) shows sandstone foundation slab beneath corner; test is 1.0 m wide



**Plate 4** South view of 50 cm deep shovel test (Sub-Op AA) shows stacked sandstone rocks buried in gravel fill; test is 50 cm by 50 cm square



**Plate 5** West view of 50 cm deep shovel test (Sub-Op C) shows wooden sill plate above undisturbed sediments and basal fluvial rocks and gravel



**Plate 6** South view of 60 cm deep test (Sub-Op's D and E) shows rotting sill plate beneath board and batten siding; test is 1.0 m wide



**Plate 7** South view of 60 to 65 cm deep tests (Sub-Op's G,H,J,K) shows sandstone foundation slab beneath original corner; test is 1.0 m square



**Plate 8** South view of 60 to 70 cm deep tests (Sub-Op's N, L, and M, left to right) shows gravel fill foundation beneath join of two buildings



**Plate 9** West view of 60 cm deep tests (Sub-Op's Q and P) shows pounded post as corner foundation; post is not fully exposed



**Plate 10** West view of 55 cm deep tests (Sub-Op's T and S) shows pounded post as corner foundation; post is not fully exposed



Plate 11 Southwest view of 35 cm deep test (Sub-Op U) shows pounded post as corner foundation; post is visible inside – it is rotting and not fully exposed



Plate 12 Southwest view of 40 cm deep test (Sub-Op V) shows off-set sandstone foundation slab beneath corner; test is 50 cm square





**Plate 13** West view of 30 cm deep test (Sub-Op W) shows sandstone foundation slabs beneath corner; test is 1.0 m wide



**Plate 14** Southeast view of 30 cm deep test (Sub-Op's Y and X) shows well-preserved wooden sill plate beneath door framework; test is 1.0 m wide



Plate 15 Southwest view of 30 cm deep 1 m by 2 m test unit (Sub-Op's BB to JJ) inside Machine Shed



Plate 16 South view of 30 cm deep soil profile (south wall of Sub-Op's BB and CC)



Plate 17 Southwest view of 30 cm deep western test unit (Sub-Op's KK to SS) inside Machine Shed



Plate 18 South view of 30 cm deep soil profile (south wall of Sub-Op's MM and NN)

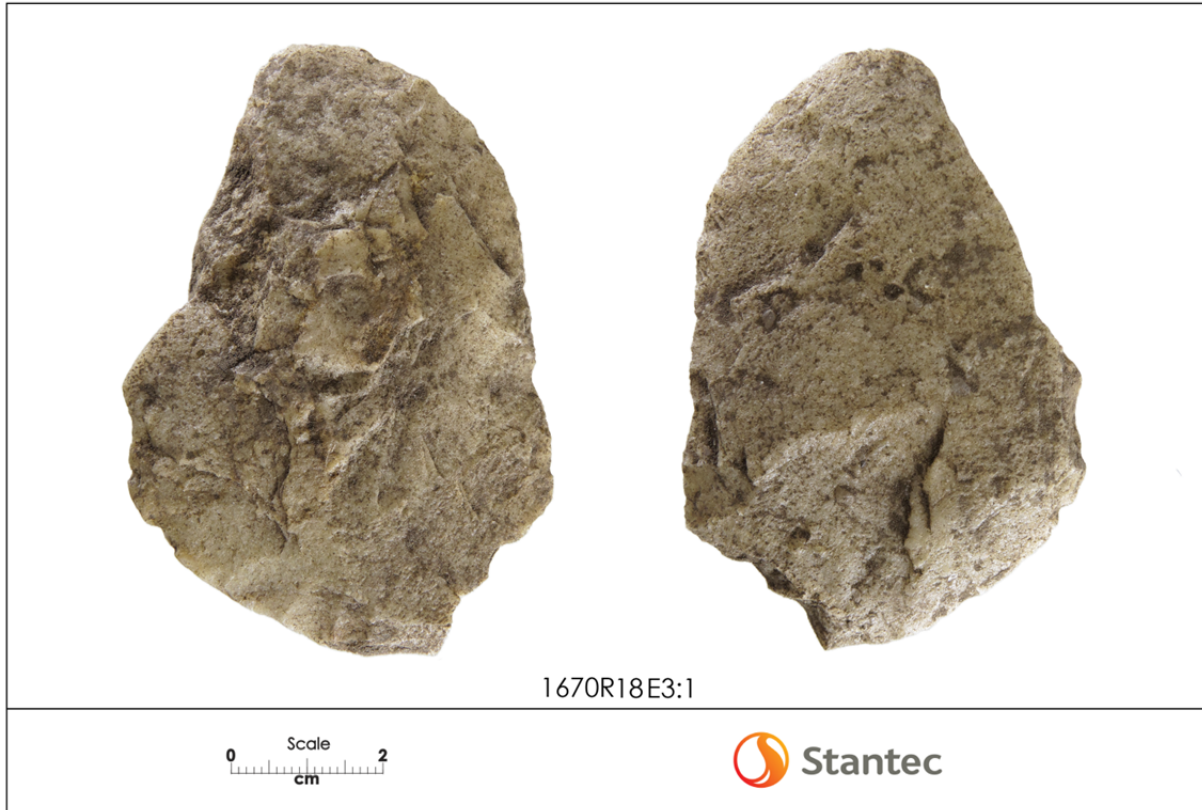


Plate 19 Views of quartzite biface recovered from outside the Historic Machine Shed

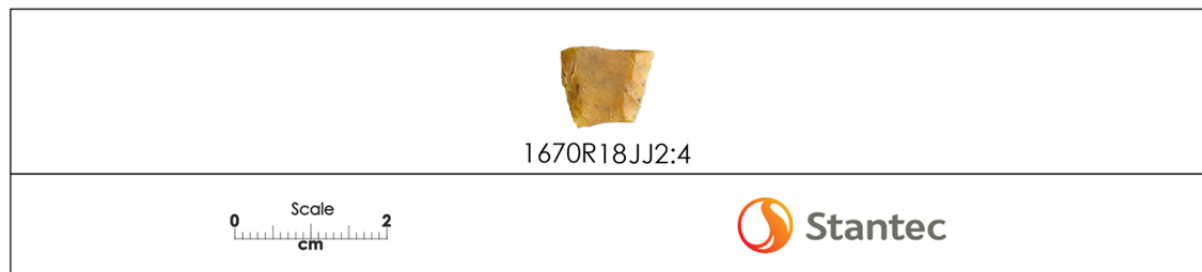


Plate 20 View of retouched chalcedony flake recovered from inside the Historic Machine Shed



**Plate 21** View of solarized manganese glass sherd recovered from inside the Historic Machine Shed



**Plate 22** Reverse and obverse views of 1919 Canadian coin recovered from inside the Historic Machine Shed

Bar U Ranch AIA for Proposed New Workshop

2015-WL-19919

Site 1670R; Operation 18

Site No.	Code	Op	Sub Op	Lot	Inv #	Qty	Object Name	Object Description	Portion	Material	Material Desc.	Mft marks/ décor.	Park Code	Collector	Date Collected	Depth	Size (cm)	Wgt (gm)	Remarks
1670	R	18	A	1	1	4	nail, common	round shank	complete	metal	ferrous	drawn	BRNHS	KB	24-Sep-15			28.7	round head, 3"; corroded
1670	R	18	A	1	2	1	unidentified wire	tools and equipment, miscellaneous	incomplete	metal	ferrous	drawn	BRNHS	KB	24-Sep-15			6.3	bent; corroded
1670	R	18	A	1	3	2	container, storage	not identified	body	metal	ferrous	interlocked side seam	BRNHS	KB	24-Sep-15			4.9	side seam can fragment
1670	R	18	A	1	4	1	unidentifiable fragment	mammal	scrap	fauna	bone		BRNHS	KB	24-Sep-15		0-3	0.2	
1670	R	18	A	1	5	12	stone, masonry	building fragment	incomplete	lithic	sandstone		BRNHS	KB	24-Sep-15			67.8	fragments of foundation construction material
1670	R	18	A	2	1	1	nail, common	round shank	complete	metal	ferrous	drawn	BRNHS	KB	24-Sep-15	10-20		7.1	round head; 3 1/4"; corroded
1670	R	18	A	2	2	1	nail, common	round shank	complete	metal	ferrous	drawn	BRNHS	KB	24-Sep-15	10-20		3.4	bent round head; head has been bent upright on opposite sides; corroded
1670	R	18	A	2	3	1	foil	unclassified container/package	incomplete	metal	grey	machine made	BRNHS	KB	24-Sep-15	10-20		0.1	small piece of foil, torn and crumpled, small amount of red colour, writing?
1670	R	18	A	2	4	1	unidentified metal fragments	miscellaneous	incomplete	metal	ferrous	not identified	BRNHS	KB	24-Sep-15	10-20		0.3	small piece of metal, corroded, shaped like a little projectile point
1670	R	18	A	2	5	1	stone, masonry	building fragment	incomplete	lithic	sandstone		BRNHS	KB	24-Sep-15	10-20		0.9	
1670	R	18	B	1	1	2	long bone	large ungulate	shaft	fauna	bone		BRNHS	KB	24-Sep-15	0-10	0-3	1.6	
1670	R	18	B	1	2	1	fencing staple	U-shaped	complete	metal	ferrous	machine	BRNHS	KB	24-Sep-15	0-10		4	corroded
1670	R	18	B	1	3	1	nail, common	round shank	complete	metal	ferrous	drawn	BRNHS	KB	24-Sep-15	0-10		2.2	round head 1 1/4"; corroded
1670	R	18	B	1	4	1	nail, common	round shank	complete	metal	ferrous	drawn	BRNHS	KB	24-Sep-15	0-10		3.7	round head; bent; corroded
1670	R	18	B	1	5	3	nail, common	round shank	complete	metal	ferrous	drawn	BRNHS	KB	24-Sep-15	0-10		21.2	round head 3"; corroded
1670	R	18	B	1	6	1	wood, finished	building fragment	incomplete	miscellaneous organic	wood	red paint	BRNHS	KB	24-Sep-15	0-10		2.8	three pieces of wood, one with red paint
1670	R	18	B	1	7	1	unidentified metal fragments	miscellaneous	incomplete	metal	ferrous	not identified	BRNHS	KB	24-Sep-15	0-10		0.6	small piece of metal, possibly tin can
1670	R	18	B	1	8	1	unidentified wire	tools and equipment, miscellaneous	incomplete	metal	ferrous	drawn	BRNHS	KB	24-Sep-15	0-10		1	bent; corroded
1670	R	18	B	1	9	1	foil	unclassified container/package	incomplete	metal	grey	machine made	BRNHS	KB	24-Sep-15	0-10		0.1	small piece of foil, in a strip, torn
1670	R	18	B	1	10	1	reinforce strap	miscellaneous tools and equipment	incomplete	metal	ferrous		BRNHS	KB	24-Sep-15	0-10		277.2	rectangular metal bar, broken on one end, 3/4" wide 1/4" thick; 4 sets of two holes, single hole at finished end with square nut and bolt, two pieces of metal used as washers on both sides
1670	R	18	B	2	1	1	unidentifiable fragment	mammal	scrap	fauna	bone		BRNHS	KB	24-Sep-15	10-20	0-3	0.6	
1670	R	18	B	2	2	1	nail, common	round shank	complete	metal	ferrous	drawn	BRNHS	KB	24-Sep-15	10-20		4.6	round head; clenched; corroded
1670	R	18	B	2	3	1	nail, common	round shank	complete	metal	ferrous	drawn	BRNHS	KB	24-Sep-15	10-20		2.8	round head; bent; corroded
1670	R	18	B	3	1	1	nail, common	round shank	complete	metal	ferrous	drawn	BRNHS	KB	24-Sep-15	20-30		6.4	round head; 2 3/4"; corroded
1670	R	18	B	3	3	7	scapula	large ungulate	blade	fauna	bone	root etched	BRNHS	KB	24-Sep-15	30-40		6.7	
1670	R	18	C	1	1	3	nail, common	round shank	complete	metal	ferrous	drawn	BRNHS	DB	24-Sep-15			6.3	round head; 2"; corroded
1670	R	18	C	1	2	1	nail, common	round shank	complete	metal	ferrous	drawn	BRNHS	DB	24-Sep-15			2.3	round head; bent; corroded

Bar U Ranch AIA for Proposed New Workshop

2015-WL-19919

Site 1670R; Operation 18

Site No.	Code	Op	Sub Op	Lot	Inv #	Qty	Object Name	Object Description	Portion	Material	Material Desc.	Mft marks/ décor.	Park Code	Collector	Date Collected	Depth	Size (cm)	Wgt (gm)	Remarks
1670	R	18	C	1	3	1	nail, common	round shank	complete	metal	ferrous	drawn	BRNHS	DB	24-Sep-15			0.5	round head; 1 1/18"; corroded
1670	R	18	C	1	4	1	paint	building fragment	incomplete	miscellaneous inorganic?	paint	red	BRNHS	DB	24-Sep-15			0.1	small red paint blob
1670	R	18	C	1	5	2	flake, secondary	complete	complete	lithic	undifferentiated coarse grained material; grey		BRNHS	DB	24-Sep-15		0.66-2.5	1.7	
1670	R	18	C	1	6	2	flake, waste/debitage	incomplete	incomplete	lithic	undifferentiated coarse grained material; grey		BRNHS	DB	24-Sep-15		0.66-2.5	0.9	
1670	R	18	C	1	7	1	flake, secondary	incomplete	proximal	lithic	quartzite; brown		BRNHS	DB	24-Sep-15		0.66-2.5	1.3	
1670	R	18	C	2	1	1	nail, common	round shank	complete	metal	ferrous	drawn	BRNHS	DB	24-Sep-15			7.1	round head; 3"; corroded
1670	R	18	C	2	2	3	nail, common	round shank	complete	metal	ferrous	drawn	BRNHS	DB	24-Sep-15			6.6	round head; 1 3/4"; corroded
1670	R	18	C	2	3	1	bottle	indeterminate	shoulder	glass	amber/brown	moulded	BRNHS	DB	24-Sep-15			3	possibly beer or medicine bottle sherd; chipped
1670	R	18	C	2	4	1	coal	coal	incomplete	lithic	coal		BRNHS	DB	24-Sep-15			0.5	
1670	R	18	C	2	5	1	long bone	large ungulate	shaft	fauna	bone		BRNHS	DB	24-Sep-15			2.9	
1670	R	18	C	2	6	1	stone, masonry	building fragment	incomplete	lithic	sandstone	traces of red paint	BRNHS	DB	24-Sep-15			1.7	
1670	R	18	C	3	1	1	long bone	large ungulate	shaft	fauna	bone	slightly gnawed	BRNHS	DB	24-Sep-15		3-9	37	
1670	R	18	C	5	1	4	unidentifiable fragment	mammal	scrap	fauna	bone	root etched	BRNHS	DB	24-Sep-15		0-3	0.6	in the river gravel
1670	R	18	D	2	1	1	brick	architectural	not identified	ceramic	other	red; moulded; fired	BRNHS	KB	24-Sep-15			0.2	dark brown silt with small pebbles
1670	R	18	D	2	2	8	nail, common	round shank	complete	metal	ferrous	drawn	BRNHS	KB	24-Sep-15			3.9	round head; 1"; corroded; dark brown silt with small pebbles
1670	R	18	D	2	3	1	nail, common	round shank	complete	metal	ferrous	drawn	BRNHS	KB	24-Sep-15			0.5	round head; bent; corroded; dark brown silt with small pebbles
1670	R	18	D	2	4	1	nail, common	round shank	complete	metal	ferrous	drawn	BRNHS	KB	24-Sep-15			2.5	round head; 2"; corroded; dark brown silt with small pebbles
1670	R	18	D	2	5	1	nail, common	round shank	complete	metal	ferrous	drawn	BRNHS	KB	24-Sep-15			6.9	round head; 3"; corroded; dark brown silt with small pebbles
1670	R	18	D	5	1	1	scapula	large ungulate	blade	fauna	bone	root etched	BRNHS	KB	24-Sep-15			1.2	in sandy river gravel
1670	R	18	D	6	1	1	rib	large ungulate	shaft	fauna	bone	root etched	BRNHS	KB	24-Sep-15			1.9	in sandy river gravel, getting really wet at 60 cm
1670	R	18	E	1	1	2	nail, common	round shank	complete	metal	ferrous	drawn	BRNHS	KB	24-Sep-15			1.1	round head; 1"; corroded; dark brown silt with small pebbles
1670	R	18	E	1	2	1	storage	not identified	closure	metal	ferrous	pressed; red paint	BRNHS	KB	24-Sep-15			11.2	round lid?; wide tabs attached to edge, trough like lever lid but much larger; painted red on exterior surface; 1670R18E2:6 seems to be more of the same; dark brown silt with small pebbles

Bar U Ranch AIA for Proposed New Workshop

2015-WL-19919

Site 1670R; Operation 18

Site No.	Code	Op	Sub Op	Lot	Inv #	Qty	Object Name	Object Description	Portion	Material	Material Desc.	Mft marks/ décor.	Park Code	Collector	Date Collected	Depth	Size (cm)	Wgt (gm)	Remarks
1670	R	18	E	1	3	1	rib	large ungulate	shaft	fauna	bone		BRNHS	KB	24-Sep-15		0-3	0.2	dark brown silt with small pebbles
1670	R	18	E	2	1	1	nail, common	round shank	complete	metal	ferrous	drawn	BRNHS	KB	24-Sep-15			6.7	round head; 3"; corroded; in north wall
1670	R	18	E	2	2	1	nail, common	round shank	complete	metal	ferrous	drawn	BRNHS	KB	24-Sep-15			7.2	round head; clenched; corroded; in north wall
1670	R	18	E	2	3	19	nail, common	round shank	complete	metal	ferrous	drawn	BRNHS	KB	24-Sep-15				round head; 1 1/8"l corroded
1670	R	18	E	2	4	2	nail, common	round shank	complete	metal	ferrous	drawn	BRNHS	KB	24-Sep-15				round head, 2 1/2"; corroded
1670	R	18	E	2	5	1	nail, common	round shank	complete	metal	ferrous	drawn	BRNHS	KB	24-Sep-15				round head; bent; corroded
1670	R	18	E	2	6	2	storage	not identified	closure	metal	ferrous	pressed; red paint	BRNHS	KB	24-Sep-15				metal tab; red painted on one surface; likely part of 1670R18E1:2
1670	R	18	E	3	1	1	biface	oval	incomplete	worked lithic	quartzite; grey	diagonally broken at base and to right lateral edge and left lateral edge to tip;	BRNHS	KB	24-Sep-15	20-30		53.6	tan brown sand/silt with pebble, gravel at 25 cm
1670	R	18	E	3	2	1	nail, common	round shank	complete	metal	ferrous	drawn	BRNHS	KB	24-Sep-15	20-30		0.8	round head; 1 1/4"; corroded; tan brown sand/silt with pebble, gravel at 25 cm
1670	R	18	E	3	3	2	nail, common	round shank	complete	metal	ferrous	drawn	BRNHS	KB	24-Sep-15	20-30		1	round head; 1"; corroded; tan brown sand/silt with pebble, gravel at 25 cm
1670	R	18	E	3	4	2	nail, common	round shank	complete	metal	ferrous	drawn	BRNHS	KB	24-Sep-15	20-30		1	round head; bent; corroded; tan brown sand/silt with pebble, gravel at 25 cm
1670	R	18	E	3	5	1	tooth root	large ungulate	root	fauna	tooth	tooth root	BRNHS	KB	24-Sep-15	20-30		0.3	tan brown sand/silt with pebble, gravel at 25 cm
1670	R	18	E	3	6	5	wood, finished	building fragment	incomplete	miscellaneous organic	wood	red paint	BRNHS	KB	24-Sep-15	20-30		17.9	tan brown sand/silt with pebble, milled wood with red paint; gravel at 25 cm
1670	R	18	E	6	1	1	long bone	large ungulate	shaft	fauna	bone	gnawed; shovel trauma	BRNHS	KB	24-Sep-15		9-15	29.9	in sandy river gravels
1670	R	18	E	6	2	2	long bone	large ungulate	shaft	fauna	bone	exfoliating; burned?	BRNHS	KB	24-Sep-15		3-9	5.4	in sandy river gravels
1670	R	18	E	6	3	1	unidentifiable fragment	mammal	scrap	fauna	bone		BRNHS	KB	24-Sep-15		0-3	0.5	in sandy river gravels
1670	R	18	E	6	4	1	hyoid	large ungulate	shaft	fauna	bone	gnawing; root etching	BRNHS	KB	24-Sep-15		3-9	1	small fragment of hyoid; sandy river gravels
1670	R	18	F	1	1	1	long bone	large ungulate	shaft	fauna	bone	gnawed	BRNHS	DB	24-Sep-15		3-9	5.6	
1670	R	18	F	1	2	1	brick	architectural	not identified	ceramic	other	orange; moulded; fired	BRNHS	DB	24-Sep-15			18.6	on surface
1670	R	18	F	1	3	1	mortar	building fragment	incomplete	lithic	plaster/mortar		BRNHS	DB	24-Sep-15			1.8	
1670	R	18	F	2	1	1	brick	architectural	not identified	ceramic	other	orange; moulded; fired	BRNHS	DB	24-Sep-15			0.7	dark brown loam; some gravel in a patch at 19 cm
1670	R	18	F	2	2	1	stone, masonry	building fragment	incomplete	lithic	sandstone		BRNHS	DB	24-Sep-15			163	dark brown loam; some gravel in a patch at 19 cm



Bar U Ranch AIA for Proposed New Workshop

2015-WL-19919

Site 1670R; Operation 18

Site No.	Code	Op	Sub Op	Lot	Inv #	Qty	Object Name	Object Description	Portion	Material	Material Desc.	Mft marks/ décor.	Park Code	Collector	Date Collected	Depth	Size (cm)	Wgt (gm)	Remarks
1670	R	18	F	3	1	1	unidentifiable fragment	large ungulate	scrap	fauna	bone		BRNHS	DB	24-Sep-15		0-3	0.5	
1670	R	18	G	1	1	2	nail, common	round shank	complete	metal	ferrous	drawn	BRNHS	KB	24-Sep-15	0-10		1.1	round head; 1"; corroded; dark brown silt with small pebbles
1670	R	18	G	1	2	1	nail, common	round shank	complete	metal	ferrous	drawn	BRNHS	KB	24-Sep-15	0-10		4.8	round head; bent; corroded; dark brown silt with small pebbles
1670	R	18	G	1	3	1	nail, common	round shank	complete	metal	ferrous	drawn	BRNHS	KB	24-Sep-15	0-10		7.2	round head; 3"; corroded; dark brown silt with small pebbles
1670	R	18	G	1	4	1	unidentified metal fragments	miscellaneous	incomplete	metal	ferrous	strip strap	BRNHS	KB	24-Sep-15	0-10		0.8	bent; corroded; dark brown silt with small pebbles
1670	R	18	G	1	5	5	bottle	indeterminate	not identified	glass	colourless	moulded	BRNHS	KB	24-Sep-15	0-10		23.9	dark brown silt with small pebbles
1670	R	18	G	2	1	1	barrel hoop?	unclassified container/package	incomplete	metal	ferrous		BRNHS	KB	25-Sep-15	10-20		208.1	1 3/4" wide strapping, two pieces overlapping; riveted together with 2 rivets; barrel stave?; corroded; dark brown silt with small pebbles
1670	R	18	G	2	2	1	unidentified metal fragments	miscellaneous	incomplete	metal	ferrous		BRNHS	KB	25-Sep-15	10-20		0.7	dark brown silt with small pebbles
1670	R	18	G	2	3	11	nail, common	round shank	incomplete	metal	ferrous	drawn	BRNHS	KB	25-Sep-15	10-20		6	round head, 1"; corroded; dark brown silt with small pebbles
1670	R	18	G	2	4	2	nail, common	round shank	incomplete	metal	ferrous	drawn	BRNHS	KB	25-Sep-15	10-20		9.8	round head, 2 1/2"; corroded; dark brown silt with small pebbles
1670	R	18	G	2	5	1	nail, common	round shank	incomplete	metal	ferrous	drawn	BRNHS	KB	25-Sep-15	10-20		7.5	round head, 3 1/4"; corroded; dark brown silt with small pebbles
1670	R	18	G	2	6	1	nail, common	round shank	incomplete	metal	ferrous	drawn	BRNHS	KB	25-Sep-15	10-20		14.7	round head, 4 1/8"; corroded; dark brown silt with small pebbles
1670	R	18	G	2	7	2	nail, common	round shank	incomplete	metal	ferrous	drawn	BRNHS	KB	25-Sep-15	10-20		1	round head, bent; corroded; dark brown silt with small pebbles
1670	R	18	G	2	8	1	nail, common	round shank	incomplete	metal	ferrous	drawn	BRNHS	KB	25-Sep-15	10-20		2.5	round head, bent; corroded; dark brown silt with small pebbles
1670	R	18	G	2	9	1	nail, common	round shank	incomplete	metal	ferrous	drawn	BRNHS	KB	25-Sep-15	10-20		4.9	round head, bent; corroded; dark brown silt with small pebbles
1670	R	18	G	2	10	1	stone, masonry	building fragment	incomplete	lithic	sandstone		BRNHS	KB	25-Sep-15	10-20		43.9	
1670	R	18	G	3	1	1	astragalus	large ungulate	incomplete	fauna	bone	missing lateral ridge of the proximal trochlea	BRNHS	KB	25-Sep-15		3-9	49.7	
1670	R	18	G	3	2	1	rib	large ungulate	shaft	fauna	bone		BRNHS	KB	25-Sep-15		0-3	1.4	
1670	R	18	G	3	3	1	rib	large ungulate	shaft	fauna	bone		BRNHS	KB	25-Sep-15		3-9	0.6	

Bar U Ranch AIA for Proposed New Workshop

2015-WL-19919

Site 1670R; Operation 18

Site No.	Code	Op	Sub Op	Lot	Inv #	Qty	Object Name	Object Description	Portion	Material	Material Desc.	Mft marks/ décor.	Park Code	Collector	Date Collected	Depth	Size (cm)	Wgt (gm)	Remarks
1670	R	18	G	3	4	1	nail, common	round shank	incomplete	metal	ferrous	drawn	BRNHS	KB	25-Sep-15			0.5	head; shank; heavily corroded
1670	R	18	G	3	5	4	nail, common	round shank	complete	metal	ferrous	drawn	BRNHS	KB	25-Sep-15			2.1	round head, 1"; heavily corroded; dark brown silt with small pebbles
1670	R	18	G	3	6	1	nail, common	round shank	complete	metal	ferrous	drawn	BRNHS	KB	25-Sep-15			2.6	round head, point bent almost into J-shape ; heavily corroded; dark brown silt with small pebbles
1670	R	18	G	3	7	3	nail, common	round shank	complete	metal	ferrous	drawn	BRNHS	KB	25-Sep-15			12.3	round head, 2 1/2"; heavily corroded; dark brown silt with small pebbles
1670	R	18	G	3	8	2	nail, common	round shank	complete	metal	ferrous	drawn	BRNHS	KB	25-Sep-15			15.9	round head, 3 1/4"; heavily corroded; dark brown silt with small pebbles
1670	R	18	G	3	9	1	nail, common	round shank	complete	metal	ferrous	drawn	BRNHS	KB	25-Sep-15			16.4	round head, 4"; heavily corroded; dark brown silt with small pebbles
1670	R	18	G	4	1	1	femur	rodent	proximal	fauna	bone		BRNHS	KB	25-Sep-15		0-3	0.3	slightly bigger than a ground squirrel; proximal end plus shaft; dark brown silt with clay, mixed at bottom half of level; faunal found in top half
1670	R	18	G	4	2	1	unidentifiable fragment	large ungulate	scrap	fauna	bone		BRNHS	KB	25-Sep-15		0-3	0.3	dark brown silt with clay, mixed at bottom half of level; faunal found in top half
1670	R	18	G	4	3	1	long bone	large ungulate	shaft	fauna	bone	shovel trauma	BRNHS	KB	25-Sep-15		3-9	2.2	dark brown silt with clay, mixed at bottom half of level; faunal found in top half
1670	R	18	H	1	1	1	long bone	large ungulate	shaft	fauna	bone		BRNHS	KB	25-Sep-15	0-10	0-3	1.1	dark brown silt, loose soil at surface
1670	R	18	H	1	2	1	nail, common	round shank	complete	metal	ferrous	drawn; red paint on head	BRNHS	KB	25-Sep-15	0-10		4.7	round head, 2 1/2"; red paint on head; corroded; dark brown silt, loose soil at surface
1670	R	18	H	2	1	1	long bone	large ungulate	shaft	fauna	bone		BRNHS	KB	25-Sep-15		0-3	2.9	possibly femur; dark brown silt
1670	R	18	H	2	2	1	nail, common	round shank	complete	metal	ferrous	drawn	BRNHS	KB	25-Sep-15			15.9	round head, 4"; corroded; dark brown silt
1670	R	18	H	2	3	1	nail, common	round shank	complete	metal	ferrous	drawn	BRNHS	KB	25-Sep-15			5.2	round head, 2 1/2"; corroded; dark brown silt
1670	R	18	H	2	4	2	stone, masonry	building fragment	incomplete	lithic	sandstone		BRNHS	KB	25-Sep-15			74.9	dark brown silt
1670	R	18	H	3	1	1	nail, common	round shank	complete	metal	ferrous	drawn	BRNHS	KB	25-Sep-15	20-30		2.3	round head, 2"; corroded; dark brown silt with a few pebbles
1670	R	18	J	1	1	1	unidentified metal fragments	miscellaneous	incomplete	metal	ferrous		BRNHS	KB	25-Sep-15	0-10		1.7	strip strap; bent corroded; dark brown silt with pebbles
1670	R	18	J	1	2	6	nail, common	round shank	complete	metal	ferrous	drawn	BRNHS	KB	25-Sep-15	0-10		3	round head; 1"; corroded; dark brown silt with pebbles

Bar U Ranch AIA for Proposed New Workshop

2015-WL-19919

Site 1670R; Operation 18

Site No.	Code	Op	Sub Op	Lot	Inv #	Qty	Object Name	Object Description	Portion	Material	Material Desc.	Mft marks/ décor.	Park Code	Collector	Date Collected	Depth	Size (cm)	Wgt (gm)	Remarks
1670	R	18	J	2	1	3	nail, common	round shank	complete	metal	ferrous	drawn	BRNHS	KB	25-Sep-15			1.4	round head, 1"; corroded; dark brown silt with small pebbles
1670	R	18	J	2	2	1	nail, common	round shank	complete	metal	ferrous	drawn	BRNHS	KB	25-Sep-15			3.7	round head, 2"; corroded; dark brown silt with small pebbles
1670	R	18	J	3	1	6	nail, common	round shank	complete	metal	ferrous	drawn	BRNHS	KB	25-Sep-15	20-30		3.4	round head, 1"; corroded; dark brown silt with small pebbles
1670	R	18	J	3	2	1	nail, common	round shank	complete	metal	ferrous	drawn	BRNHS	KB	25-Sep-15	20-30		0.4	round head; bent; corroded; dark brown silt with small pebbles
1670	R	18	J	3	3	1	nail, common	round shank	complete	metal	ferrous	drawn	BRNHS	KB	25-Sep-15	20-30		2.3	round head, 2"; corroded; dark brown silt with small pebbles
1670	R	18	J	3	4	2	nail, common	round shank	complete	metal	ferrous	drawn	BRNHS	KB	25-Sep-15	20-30		9.2	round head; bent; corroded; dark brown silt with small pebbles
1670	R	18	J	3	5	2	nail, common	round shank	complete	metal	ferrous	drawn	BRNHS	KB	25-Sep-15	20-30		12.7	round head, 3"; corroded; dark brown silt with small pebbles
1670	R	18	J	3	6	1	long bone	large ungulate	shaft	fauna	bone	shovel trauma	BRNHS	KB	25-Sep-15	20-30	3-9	2.3	dark brown silt with small pebbles
1670	R	18	K	1	1	1	nail, common	round shank	complete	metal	ferrous	drawn	BRNHS	KB	25-Sep-15			0.5	round head, 1"; corroded; dark brown silt and sod
1670	R	18	K	2	1	3	nail, common	round shank	complete	metal	ferrous	drawn	BRNHS	KB	25-Sep-15			1.5	round head, 1"; corroded; dark brown silt
1670	R	18	K	2	2	1	unidentified metal fragments	miscellaneous	incomplete	metal	ferrous		BRNHS	KB	25-Sep-15			1.9	bent; corroded; dark brown silt
1670	R	18	K	2	3	1	unidentified metal fragments	miscellaneous	incomplete	metal	ferrous	with two nails	BRNHS	KB	25-Sep-15			7.1	bent; corroded; two nails hammered in at one end; dark brown silt
1670	R	18	K	2	4	3	stone, masonry	building fragment	incomplete	lithic	sandstone		BRNHS	KB	25-Sep-15			65.3	dark brown silt
1670	R	18	K	2	5	2	long bone	large ungulate	shaft	fauna	bone	gnawed; shovel trauma	BRNHS	KB	25-Sep-15			6.1	dark brown silt
1670	R	18	K	3	1	1	long bone	large ungulate	shaft	fauna	bone		BRNHS	KB	25-Sep-15		0-3	0.6	looks like a flake of bone
1670	R	18	L	1	1	1	flake, primary	complete	complete	lithic	siltstone; grey	cortex covers dorsal surface	BRNHS	DB	25-Sep-15	0-10	0.66-2.5	0.4	small decort flake; in the gravel fill
1670	R	18	L	3	1	1	nail, common	round shank	complete	metal	ferrous	drawn	BRNHS	KB	25-Sep-15			2.5	round head, 2"; corroded
1670	R	18	L	3	2	1	unidentified wire	tools and equipment, miscellaneous	incomplete	metal	ferrous	drawn	BRNHS	KB	25-Sep-15	22		4.8	bent; corroded
1670	R	18	L	3	3	2	unidentifiable fragment	large ungulate	scrap	fauna	bone		BRNHS	KB	25-Sep-15			0.9	
1670	R	18	L	4	1	1	flake, waste/debitage	indeterminate	incomplete	lithic	siltstone; grey		BRNHS	DB	25-Sep-15		0.66-2.5	1.4	near proximal end, platform crushed
1670	R	18	M	1	1	1	long bone	large ungulate	scrap	fauna	bone		BRNHS	DB	25-Sep-15			0.7	
1670	R	18	M	1	2	1	wood, finished	building fragment	incomplete	miscellaneous organic	wood	two nail holes	BRNHS	DB	25-Sep-15			0.9	squared off at one end, 2 nail holes; appears to be planed on one site

Bar U Ranch AIA for Proposed New Workshop

2015-WL-19919

Site 1670R; Operation 18

Site No.	Code	Op	Sub Op	Lot	Inv #	Qty	Object Name	Object Description	Portion	Material	Material Desc.	Mft marks/ décor.	Park Code	Collector	Date Collected	Depth	Size (cm)	Wgt (gm)	Remarks
1670	R	18	M	1	3	2	unidentifiable fragment	indeterminate	not identified	glass	clear	bloom; chipped	BRNHS	DB	25-Sep-15	0-3		0.8	curved glass, possibly bottle
1670	R	18	M	1	4	1	nail, finishing	round shank	complete	metal	ferrous	drawn	BRNHS	DB	25-Sep-15			1.7	finishing nail; corroded 1 3/4"
1670	R	18	M	1	5	1	nail, finishing	round shank	complete	metal	ferrous	drawn	BRNHS	DB	25-Sep-15			1.9	finishing nail; bent; corroded
1670	R	18	M	2	1	1	thoracic vertebra	bird; large	incomplete	fauna	bone	fused	BRNHS	DB	25-Sep-15		0-3	2.7	posterior centrum, neural arch, part of spine present; fused
1670	R	18	M	2	2	3	rib	large ungulate	shaft	fauna	bone		BRNHS	DB	25-Sep-15		0-3	2.5	
1670	R	18	M	2	3	1	unidentifiable fragment	large ungulate	scrap	fauna	bone	heavily gnawed	BRNHS	DB	25-Sep-15		0-3	2.1	heavily gnawed
1670	R	18	M	2	4	2	nail, common	round shank	complete	metal	ferrous	drawn	BRNHS	DB	25-Sep-15			1.1	round head 1"; corroded
1670	R	18	M	2	5	2	nail, common	round shank	complete	metal	ferrous	drawn	BRNHS	DB	25-Sep-15			4.4	round head 2"; corroded
1670	R	18	M	2	6	3	unidentified wire	tools and equipment, miscellaneous	incomplete	metal	ferrous	drawn	BRNHS	DB	25-Sep-15			8.2	bent; corroded
1670	R	18	M	5	1	1	tibia	large mammal	distal, anterior, lateral	fauna	bone	left; weathered	BRNHS	DB	25-Sep-15		3-9	24.5	Bos/Equus
1670	R	18	N	1	1	1	unidentified wire	tools and equipment, miscellaneous	incomplete	metal	ferrous	drawn	BRNHS	DB	25-Sep-15			2	bent; corroded
1670	R	18	N	1	2	1	mortar	building fragment	incomplete	lithic	plaster/mortar		BRNHS	DB	25-Sep-15			2.6	
1670	R	18	N	2	1	2	rib	large ungulate	shaft	fauna	bone		BRNHS	DB	25-Sep-15		0-3	0.9	
1670	R	18	N	2	2	1	pane, window	window	incomplete	glass	colourless	rolled	BRNHS	DB	25-Sep-15			4.4	
1670	R	18	N	3	1	1	long bone	large ungulate	shaft	fauna	bone	gnawed; shovel trauma	BRNHS	DB	25-Sep-15		3-9	6	
1670	R	18	N	3	2	1	tooth	large mammal	incisor	fauna	tooth	very worn incisor or p2	BRNHS	DB	25-Sep-15		0-3	1.9	Bos/Equus
1670	R	18	N	3	3	2	nail, common	round shank	complete	metal	ferrous	drawn	BRNHS	DB	25-Sep-15			1	round head; 1"; corroded
1670	R	18	N	3	4	1	nail, common	round shank	complete	metal	ferrous	drawn	BRNHS	DB	25-Sep-15			2.5	round head; 2"; corroded
1670	R	18	N	3	5	1	nail, common	round shank	complete	metal	ferrous	drawn	BRNHS	DB	25-Sep-15			3.8	round head; bent; corroded
1670	R	18	N	3	6	1	nail, common	round shank	head; shank	metal	ferrous	drawn	BRNHS	DB	25-Sep-15			4.6	no head; corroded
1670	R	18	N	4	1	1	flake, waste/debitage	indeterminate	incomplete	lithic	siltstone; grey		BRNHS	DB	25-Sep-15		0.66-2.5	1.4	near proximal end, platform crushed
1670	R	18	P	3	1	1	long bone	large ungulate	shaft	fauna	bone		BRNHS	KB	25-Sep-15	20-30	0-3	1	dark brown silt with small pebbles intermittent
1670	R	18	P	4	1	1	rib	large ungulate	shaft	fauna	bone	root etched; shovel trauma	BRNHS	KB	25-Sep-15	30-40	3-9	1.2	dark brown silt with slight clay content
1670	R	18	P	4	2	12	cranial	large ungulate	incomplete	fauna	bone		BRNHS	KB	25-Sep-15	32	0-3	9.2	dark brown silt with small pebbles
1670	R	18	P	4	3	3	cranial	large ungulate	incomplete	fauna	bone		BRNHS	KB	25-Sep-15	32	3-9	17.1	dark brown silt with small pebbles
1670	R	18	P	4	4	1	cranial	large ungulate	incomplete	fauna	bone		BRNHS	KB	25-Sep-15	32	9-15	24.3	dark brown silt with small pebbles
1670	R	18	P	4	5	1	internal auditory meatus	bovid	complete	fauna	bone	plus some external auditory meatus	BRNHS	KB	25-Sep-15	32	3-9	36.9	dark brown silt with small pebbles
1670	R	18	Q	1	1	1	nail, common	round shank	complete	metal	ferrous	drawn	BRNHS	KB	25-Sep-15	0-10		1.7	round head; bent; corroded; dark brown silt with small pebbles

Bar U Ranch AIA for Proposed New Workshop

2015-WL-19919

Site 1670R; Operation 18

Site No.	Code	Op	Sub Op	Lot	Inv #	Qty	Object Name	Object Description	Portion	Material	Material Desc.	Mft marks/ décor.	Park Code	Collector	Date Collected	Depth	Size (cm)	Wgt (gm)	Remarks
1670	R	18	Q	2	1	1	synsacrum	bird; medium	incomplete	fauna	bone	chicken size	BRNHS	KB	25-Sep-15		3-9	3.3	1670R18Q2:1-3 articulate
1670	R	18	Q	2	2	1	lumbar vertebra	bird; medium	complete	fauna	bone	chicken size	BRNHS	KB	25-Sep-15		0-3	0.8	1670R18Q2:1-3 articulate
1670	R	18	Q	2	3	1	lumbar vertebra	bird; medium	incomplete	fauna	bone	chicken size	BRNHS	KB	25-Sep-15		0-3	0.4	1670R18Q2:1-3 articulate
1670	R	18	Q	2	4	1	vertebra	bird; medium	incomplete	fauna	bone	chicken size	BRNHS	KB	25-Sep-15		0-3	0.2	
1670	R	18	Q	2	5	1	cranial	large ungulate	incomplete	fauna	bone		BRNHS	KB	25-Sep-15		0-3	0.9	
1670	R	18	Q	2	6	1	cranial	large ungulate	incomplete	fauna	bone	cow/bison/horse sized	BRNHS	KB	25-Sep-15		9-15	23.4	
1670	R	18	Q	3	1	1	pane, window	window	incomplete	glass	colourless	rolled	BRNHS	KB	25-Sep-15	20-30		0.4	dark brown silt with small pebbles
1670	R	18	Q	3	2	1	cranial	large ungulate	incomplete	fauna	bone		BRNHS	KB	25-Sep-15	20-30	3-9	29.1	
1670	R	18	Q	3	3	1	long bone	large ungulate	shaft	fauna	bone		BRNHS	KB	25-Sep-15	20-30	3-9	14.7	
1670	R	18	Q	3	4	1	unidentifiable fragment	mammal	scrap	fauna	bone		BRNHS	KB	25-Sep-15	20-30	0-3	0.9	
1670	R	18	Q	3	5	1	long bone	large ungulate	shaft	fauna	bone	spiral fracture; very worn	BRNHS	KB	25-Sep-15	20-30	3-9	13	
1670	R	18	R	2	1	1	rib	large ungulate	shaft	fauna	bone		BRNHS	DB	28-Sep-15		3-9	1.9	
1670	R	18	R	2	2	1	tooth	large mammal	incisor	fauna	tooth	very worn	BRNHS	DB	28-Sep-15		0-3	0.9	Bos/Equus
1670	R	18	R	3	1	1	cancellous tissue	large ungulate?	scrap	fauna	bone		BRNHS	DB	28-Sep-15		0-3	0.8	
1670	R	18	R	4	1	1	unidentifiable fragment	large ungulate	scrap	fauna	bone		BRNHS	DB	28-Sep-15		0-3	0.4	
1670	R	18	R	4	2	1	scapula	large ungulate	distal, posterior border	fauna	bone	very worn	BRNHS	DB	28-Sep-15		3-9	25.6	distal posterior portion of blade
1670	R	18	R	4	3	1	FBR	indeterminate	undetermined	lithic	quartzite; grey	slightly reddened	BRNHS	DB	28-Sep-15		5-10	50.4	slightly reddened
1670	R	18	R	5	1	1	P-1	bos/bison	complete	fauna	bone	right; gnawed	BRNHS	DB	28-Sep-15		3-9	56.3	
1670	R	18	R	5	2	1	long bone	large ungulate	shaft	fauna	bone		BRNHS	DB	28-Sep-15		0-3	2.2	
1670	R	18	R	6	1	1	synsacrum	bird; medium/small	complete	fauna	bone		BRNHS	DB	28-Sep-15		0-3	0.5	smaller than a chicken, bigger than a songbird; pelvis attached; soft pockets of ark brown sand in the clayey sand - rodent tunnels
1670	R	18	R	7	1	1	femur	rodent	complete	fauna	bone	unfused proximal end	BRNHS	DB	28-Sep-15		0-3	0.2	rodent complete minus unfused proximal end
1670	R	18	S	4	1	1	thoracic vertebra	small ungulate	articular surface; spinous process	fauna	bone		BRNHS	KB	28-Sep-15		3-9	2.3	one posterior articular process and small piece of spinous process; small ungulate?
1670	R	18	T	1	1	1	unidentified wire	tools and equipment, miscellaneous	incomplete	metal	ferrous	drawn	BRNHS	KB	28-Sep-15			12.1	bent; corroded; dark brown silt with clay and gravel associated with inside of shed
1670	R	18	T	1	2	2	nail, common	round shank	complete	metal	ferrous	drawn	BRNHS	KB	28-Sep-15			1.1	round head, 1"; corroded; dark brown silt with clay and gravel associated with inside of shed
1670	R	18	T	1	3	1	nail, common	round shank	complete	metal	ferrous	drawn	BRNHS	KB	28-Sep-15			1.7	round head, 2"; corroded; dark brown silt with clay and gravel associated with inside of shed

Bar U Ranch AIA for Proposed New Workshop

2015-WL-19919

Site 1670R; Operation 18

Site No.	Code	Op	Sub Op	Lot	Inv #	Qty	Object Name	Object Description	Portion	Material	Material Desc.	Mft marks/ décor.	Park Code	Collector	Date Collected	Depth	Size (cm)	Wgt (gm)	Remarks
1670	R	18	T	1	4	1	nail, common	round shank	complete	metal	ferrous	drawn	BRNHS	KB	28-Sep-15			3.5	round head, 2 1/2"; corroded; dark brown silt with clay and gravel associated with inside of shed
1670	R	18	T	1	5	1	nail, common	round shank	complete	metal	ferrous	drawn	BRNHS	KB	28-Sep-15			4.5	round head, bent; corroded; dark brown silt with clay and gravel associated with inside of shed
1670	R	18	T	1	6	1	crown cap	closure	complete	metal	ferrous	bent	BRNHS	KB	28-Sep-15			3	red and black band inside white with gold maple leaf; Molson beer bottle cap
1670	R	18	T	2	1	1	nail, common	round shank	complete	metal	ferrous	drawn	BRNHS	KB	28-Sep-15	10-20		11	round head; 3 1/2" corroded; dark brown silt with clay and gravel
1670	R	18	T	2	2	1	barbed wire	tools and equipment, miscellaneous	incomplete	metal	ferrous	drawn	BRNHS	KB	28-Sep-15	10-20		25.9	two barbs on each end of a length of double strand wire; bent; corroded
1670	R	18	T	2	3	1	phalanx	pig?	proximal	fauna	bone	sawn proximal end of second phalanx; pig size	BRNHS	KB	28-Sep-15	10-20	0-3	1	sawn proximal end
1670	R	18	T	2	4	2	rib	large ungulate	shaft	fauna	bone		BRNHS	KB	28-Sep-15	10-20	0-3	1.8	
1670	R	18	T	3	1	2	scapula	large ungulate	blade	fauna	bone	edge of blade	BRNHS	KB	28-Sep-15		0-3	1.9	dark brown silt with clay; lots of gravel associated with barn and road
1670	R	18	T	3	2	1	scapula	bos/bison	proximal	fauna	bone	right; proximal end plus blade	BRNHS	KB	28-Sep-15		>15	209.1	right; complete glenoid plus neck and part of blade; spine broken away; shovel trauma; larger individual; in north wall; dark brown silt/clay/sand with lots of gravel
1670	R	18	T	3	3	1	scapula	bos/bison	proximal	fauna	bone	right; proximal end plus blade	BRNHS	KB	28-Sep-15		>15	141.6	right; complete glenoid plus neck and part of blade; spine broken away; smaller individual; dark brown silt/clay/sand with lots of gravel
1670	R	18	U	1	1	2	nail, common	round shank	complete	metal	ferrous	drawn	BRNHS	DB	28-Sep-15			1.1	round head, 1"; corroded; gravel fill on surface
1670	R	18	U	1	2	1	nail, common	round shank	complete	metal	ferrous	drawn	BRNHS	DB	28-Sep-15			2.4	round head, bent; corroded; gravel fill on surface
1670	R	18	U	1	3	1	nail, horseshoe	square/rect. shank	head; shank	metal	ferrous	machine cut	BRNHS	DB	28-Sep-15			5.3	corroded; gravel fill on surface
1670	R	18	U	1	4	1	screw, wood	Robertson	complete	metal	ferrous	machine; countersunk	BRNHS	DB	28-Sep-15			4.2	Robertson screw; countersunk; 2 1/2"; corroded; gravel fill on surface

Bar U Ranch AIA for Proposed New Workshop

2015-WL-19919

Site 1670R; Operation 18

Site No.	Code	Op	Sub Op	Lot	Inv #	Qty	Object Name	Object Description	Portion	Material	Material Desc.	Mft marks/ décor.	Park Code	Collector	Date Collected	Depth	Size (cm)	Wgt (gm)	Remarks
1670	R	18	U	1	5	1	screw, wood	slot	complete	metal	ferrous	machine; countersunk	BRNHS	DB	28-Sep-15			4.9	slot screw; countersunk; red paint on head; 1 1/2"; ; gravel fill on surface
1670	R	18	U	1	6	1	washer	round	complete	metal	ferrous	cast	BRNHS	DB	28-Sep-15			1	gravel fill on surface
1670	R	18	U	1	7	3	nut	square, threaded	complete	metal	ferrous	cast; red paint	BRNHS	DB	28-Sep-15			10.6	small square nuts with red paint; gravel fill on surface
1670	R	18	U	1	8	1	button	clothing accessory	complete	fauna	shell		BRNHS	DB	28-Sep-15			0.8	9/16" white shell button; 4-hole centre depressed; chalking
1670	R	18	U	2	1	1	nail, common	round shank	complete	metal	ferrous	drawn	BRNHS	DB	28-Sep-15			4.8	round head; 2 1/2"; corroded; less gravel fill
1670	R	18	U	2	2	1	screw, wood	slot	complete	metal	ferrous	machine; countersunk	BRNHS	DB	28-Sep-15			4.7	slot screw; countersunk; 1 1/2"; less gravel fill on surface
1670	R	18	U	2	3	1	nail, common	round shank	complete	metal	ferrous	drawn	BRNHS	DB	28-Sep-15			3.4	corroded; less gravel fill
1670	R	18	U	2	4	1	tooth root	large ungulate	root	fauna	tooth		BRNHS	DB	28-Sep-15		0-3	2.7	less gravel fill
1670	R	18	U	2	5	1	rib	large ungulate	shaft	fauna	bone	root etched	BRNHS	DB	28-Sep-15		3-9	4.2	less gravel fill
1670	R	18	U	2	6	0	elastic band	complete	complete	miscellaneous inorganic	plastic	blue elastic band	BRNHS	DB	28-Sep-15			1.2	less gravel fill
1670	R	18	V	1	1	2	nail, common	round shank	complete	metal	ferrous	drawn	BRNHS	KB	28-Sep-15			1.2	round head, 1"; corroded; brown silt with gravel associated with road and inside of shed
1670	R	18	V	1	2	1	nail, common	round shank	complete	metal	ferrous	drawn	BRNHS	KB	28-Sep-15			0.5	round head, bent; corroded; brown silt with gravel associated with road and inside of shed
1670	R	18	V	1	3	1	nail, common	round shank	complete	metal	ferrous	drawn	BRNHS	KB	28-Sep-15			0.8	round head, 1 1/4"; corroded; brown silt with gravel associated with road and inside of shed
1670	R	18	V	1	4	1	nail, common	round shank	complete	metal	ferrous	drawn	BRNHS	KB	28-Sep-15			2.7	finishing nail, bent; corroded; brown silt with gravel associated with road and inside of shed
1670	R	18	V	1	5	1	nail, common	round shank	complete	metal	ferrous	drawn	BRNHS	KB	28-Sep-15			2.5	head obscured by corrosion; 2"; red paint on the shank; brown silt with gravel associated with road and inside of shed
1670	R	18	V	1	6	2	nail, common	round shank	complete	metal	ferrous	drawn	BRNHS	KB	28-Sep-15			4.3	round head; clenched; corroded; brown silt with gravel associated with road and inside of shed
1670	R	18	V	1	7	3	screw, wood	slot	complete	metal	ferrous	machine; countersunk	BRNHS	KB	28-Sep-15			15	slot screw; countersunk; 1 1/2"; corroded; brown silt with gravel associated with road and inside of shed

Bar U Ranch AIA for Proposed New Workshop

2015-WL-19919

Site 1670R; Operation 18

Site No.	Code	Op	Sub Op	Lot	Inv #	Qty	Object Name	Object Description	Portion	Material	Material Desc.	Mft marks/ décor.	Park Code	Collector	Date Collected	Depth	Size (cm)	Wgt (gm)	Remarks
1670	R	18	V	1	8	1	screw, wood	slot	complete	metal	ferrous	machine; countersunk	BRNHS	KB	28-Sep-15			4.7	slot screw; countersunk; bent; corroded; brown silt with gravel associated with road and inside of shed
1670	R	18	V	1	9	1	screw, wood	Robertson	complete	metal	ferrous	machine; countersunk	BRNHS	KB	28-Sep-15			4.1	Robertson screw; countersunk; 2 1/2"; corroded; brown silt with gravel associated with road and inside of shed
1670	R	18	V	1	10	1	screw, wood	Robertson	complete	metal	ferrous	machine; countersunk	BRNHS	KB	28-Sep-15			4.9	Robertson screw; countersunk; 3"; corroded; brown silt with gravel associated with road and inside of shed
1670	R	18	V	1	11	3	nail, common	round shank	complete	metal	ferrous	drawn	BRNHS	KB	28-Sep-15			47.2	round head, 4"; corroded; brown silt with gravel associated with road and inside of shed
1670	R	18	V	1	12	2	nail, common	round shank	complete	metal	ferrous	drawn	BRNHS	KB	28-Sep-15			31.2	round head, bent; corroded; probably also 4"; brown silt with gravel associated with road and inside of shed
1670	R	18	V	1	13	1	nail, common	round shank	complete	metal	ferrous	drawn	BRNHS	KB	28-Sep-15			4.5	round head, bent; corroded; red paint on head; gravel fill on surface
1670	R	18	V	1	14	2	nail, common	round shank	complete	metal	ferrous	drawn	BRNHS	KB	28-Sep-15			10.2	round head, bent; corroded; brown silt with gravel associated with road and inside of shed
1670	R	18	V	1	15	1	nail, common	round shank	complete	metal	ferrous	drawn	BRNHS	KB	28-Sep-15			27.5	round head, bent; corroded; long nail, approx 5"; brown silt with gravel associated with road and inside of shed
1670	R	18	W	1	1	2	nail, common	round shank	shank; point	metal	ferrous	drawn	BRNHS	DB	28-Sep-15			0.9	bent; corroded
1670	R	18	W	1	2	4	nail, common	round shank	head; shank	metal	ferrous	drawn	BRNHS	DB	28-Sep-15			1.7	corroded, smaller size nails
1670	R	18	W	1	3	5	nail, common	round shank	head; shank	metal	ferrous	drawn	BRNHS	DB	28-Sep-15			50.8	large nails, corroded
1670	R	18	W	1	4	7	nail, common	round shank	complete	metal	ferrous	drawn	BRNHS	DB	28-Sep-15			4.1	round head; 1"; corroded
1670	R	18	W	1	5	2	nail, common	round shank	complete	metal	ferrous	drawn	BRNHS	DB	28-Sep-15			4.3	round head, 2"; corroded
1670	R	18	W	1	6	3	nail, common	round shank	complete	metal	ferrous	drawn	BRNHS	DB	28-Sep-15			11.2	round head, 2 1/2"; corroded
1670	R	18	W	1	7	2	nail, common	round shank	complete	metal	ferrous	drawn	BRNHS	DB	28-Sep-15			13.3	round head, 3"; corroded
1670	R	18	W	1	8	2	nail, common	round shank	complete	metal	ferrous	drawn	BRNHS	DB	28-Sep-15			31.6	round head, 4"; corroded
1670	R	18	W	1	9	1	nail, common	round shank	complete	metal	ferrous	drawn	BRNHS	DB	28-Sep-15			6.8	round head, bent; corroded
1670	R	18	W	1	10	1	bolt	carriage	head; shank	metal	ferrous	cast	BRNHS	DB	28-Sep-15			17.5	corroded
1670	R	18	W	1	11	3	not identified	unidentified	not identified	ceramic	earthenware	moulded; fired; glazed	BRNHS	DB	28-Sep-15			2.2	white; chipped; crazed; small sherds, likely dinnerware
1670	R	18	W	2	1	1	nail, common	round shank	complete	metal	ferrous	drawn	BRNHS	DB	28-Sep-15			1.3	corroded
1670	R	18	W	2	2	1	nail, common	round shank	complete	metal	ferrous	drawn	BRNHS	DB	28-Sep-15			0.6	round head; 1"; corroded
1670	R	18	W	2	3	1	long bone	large ungulate	shaft	fauna	bone	root etched	BRNHS	DB	28-Sep-15		0-3	2.2	



Bar U Ranch AIA for Proposed New Workshop

2015-WL-19919

Site 1670R; Operation 18

Site No.	Code	Op	Sub Op	Lot	Inv #	Qty	Object Name	Object Description	Portion	Material	Material Desc.	Mft marks/ décor.	Park Code	Collector	Date Collected	Depth	Size (cm)	Wgt (gm)	Remarks
1670	R	18	W	1-4	1	1	unknown	non-mechanized transport?	complete	metal	ferrous	cast	BRNHS	DB	28-Sep-15				3/4" diameter round metal bar with threading on each end, large square nut (1 1/4") twisted onto one end; upright nut at 2 cm bs, other end at 33 cm bs
1670	R	18	X	1	1	1	unknown	hardware?	complete	metal	ferrous	cast	BRNHS	KB	28-Sep-15			136.9	2 1/2" plate with two rounded sides and two straight sides; raised in the centre; 3/4" hole, no threading; no holes for fasteners; dark brown silt with lots of gravel/glass/metal
1670	R	18	X	1	2	5	nail, common	round shank	complete	metal	ferrous	drawn	BRNHS	KB	28-Sep-15			3.5	round head; 1"; corroded; dark brown silt with lots of gravel/glass/metal
1670	R	18	X	1	3	6	nail, common	round shank	complete	metal	ferrous	drawn	BRNHS	KB	28-Sep-15			13.8	round head; 2"; corroded; dark brown silt with lots of gravel/glass/metal
1670	R	18	X	1	4	1	nail, common	round shank	shank; point	metal	ferrous	drawn	BRNHS	KB	28-Sep-15			2.6	shank; point; bent; corroded; "J" shaped; dark brown silt with lots of gravel/glass/metal
1670	R	18	X	1	5	1	cranial	large ungulate	incomplete	fauna	bone		BRNHS	KB	28-Sep-15		0-3	0.6	dark brown silt with lots of gravel/glass/metal
1670	R	18	X	1	6	7	bottle	indeterminate	not identified	glass	colourless	moulded	BRNHS	KB	28-Sep-15			6.9	clear bottle glass sherds; moulded; dark brown silt with lots of gravel/glass/metal
1670	R	18	X	1	7	1	bottle	indeterminate	base	glass	colourless	embossed", E...diamond D...3"	BRNHS	KB	28-Sep-15			21.6	stippled base with Dominion Glass maker's mark , Radcliffe, Alberta, precede by "E", followed by "3", either 1943 or 1953, perhaps 1953 because of presence of stippling; dark brown silt with lots of gravel/glass/metal
1670	R	18	X	2	1	2	rib	large ungulate	shaft	fauna	bone	shovel trauma; root etched	BRNHS	KB	28-Sep-15		3-9	14.8	slightly porous texture; two pieces of rib, one piece slightly porous texture; refits with 1670R18X3:1; dark brown silt/sand/gravel
1670	R	18	X	3	1	1	rib	large ungulate	shaft	fauna	bone	shovel trauma; root etched	BRNHS	KB	28-Sep-15		3-9	5.1	refits with one piece of 1670R18X1:1; sand/gravel with large cobbles
1670	R	18	X	3	2	1	nail, common	round shank	complete	metal	ferrous	drawn	BRNHS	KB	28-Sep-15			2.5	round head; 2"; corroded; sand/gravel with large cobbles
1670	R	18	Y	1	1	1	carpometacarpus	bird; small	shaft; distal	fauna	bone		BRNHS	KB	28-Sep-15		0-3	0.2	sod with dark brown silt
1670	R	18	Y	1	2	1	unidentified wire	tools and equipment, miscellaneous	incomplete	metal	ferrous	drawn	BRNHS	KB	28-Sep-15			1.4	bent; corroded; sod with dark brown silt
1670	R	18	Y	1	3	2	nail, common	round shank	complete	metal	ferrous	drawn	BRNHS	KB	28-Sep-15			1	round head; 1" corroded; sod with dark brown silt

Bar U Ranch AIA for Proposed New Workshop

2015-WL-19919

Site 1670R; Operation 18

Site No.	Code	Op	Sub Op	Lot	Inv #	Qty	Object Name	Object Description	Portion	Material	Material Desc.	Mft marks/ décor.	Park Code	Collector	Date Collected	Depth	Size (cm)	Wgt (gm)	Remarks
1670	R	18	Y	1	4	2	nail, common	round shank	complete	metal	ferrous	drawn	BRNHS	KB	28-Sep-15			4.3	round head; 2" corroded; sod with dark brown silt
1670	R	18	Y	1	5	1	nail, common	round shank	complete	metal	ferrous	drawn	BRNHS	KB	28-Sep-15			2.3	round head; bent; corroded; red paint on head and half of shaft; sod with dark brown silt
1670	R	18	Y	1	6	1	nail, common	round shank	complete	metal	ferrous	drawn	BRNHS	KB	28-Sep-15			2	round head; bent; corroded; sod with dark brown silt
1670	R	18	Y	1	7	1	nail, common	round shank	complete	metal	ferrous	drawn	BRNHS	KB	28-Sep-15			4.4	round head bent; corroded; sod with dark brown silt
1670	R	18	Y	1	8	5	nail, common	round shank	complete	metal	ferrous	drawn	BRNHS	KB	28-Sep-15			25.7	round head; 3"; corroded; sod with dark brown silt
1670	R	18	Y	1	9	1	nail, common	round shank	complete	metal	ferrous	drawn	BRNHS	KB	28-Sep-15			29.9	round head 5"; corroded; sod with dark brown silt
1670	R	18	Y	2	1	3	nail, common	round shank	head; shank	metal	ferrous	drawn	BRNHS	KB	28-Sep-15			1.5	round head; corroded; 10-15 cm dark brown silt with gravel; 15-20 cm sand with gravel
1670	R	18	Y	2	2	1	long bone	large ungulate	shaft	fauna	bone	root etched	BRNHS	KB	28-Sep-15		0-3	4.4	10-15 cm dark brown silt with gravel; 15-20 cm sand with gravel
1670	R	18	AA	1	1	1	fencing staple	U-shaped	complete	metal	ferrous	machine	BRNHS	DB/KB	29-Sep-15			6.1	corroded
1670	R	18	AA	2	1	1	nail, common	round shank	head; shank	metal	ferrous	drawn	BRNHS	DB/KB	29-Sep-15			3.6	round head; 2 1/2" corroded
1670	R	18	AA	2	2	1	long bone	bird; large	shaft	fauna	bone		BRNHS	DB/KB	29-Sep-15		0-3	0.8	large shaft fragment; large bird
1670	R	18	AA	3	1	1	long bone	large ungulate	shaft	fauna	bone		BRNHS	DB/KB	29-Sep-15		0-3	1.5	
1670	R	18	AA	3	2	1	nail, common	round shank	head; shank	metal	ferrous	drawn	BRNHS	DB/KB	29-Sep-15			2.1	round head 3"; corroded
1670	R	18	AA	3	3	1	nail, common	round shank	head; shank	metal	ferrous	drawn	BRNHS	DB/KB	29-Sep-15			7.2	round head, 2 7/8"; corroded
1670	R	18	AA	4	1	1	nail, common	round shank	head; shank	metal	ferrous	drawn	BRNHS	DB/KB	29-Sep-15	31-44		0.4	round head, 1 1/4"; corroded
1670	R	18	AA	4	2	2	nail, common	round shank	head; shank	metal	ferrous	drawn	BRNHS	DB/KB	29-Sep-15	31-44		4.4	round head, 2"; corroded
1670	R	18	AA	4	3	1	bottle	indeterminate	body	glass	amber/brown	moulded	BRNHS	DB/KB	29-Sep-15	31-44		9.6	fairly thick glass, perhaps from a carboy?
1670	R	18	AA	4	4	1	long bone	large ungulate	shaft	fauna	bone		BRNHS	DB/KB	29-Sep-15	31-44		1.8	
1670	R	18	AA	5	1	5	long bone	large ungulate	shaft	fauna	bone		BRNHS	DB/KB	29-Sep-15		3-9	14.4	
1670	R	18	BB	1	1	2	long bone	large ungulate	shaft	fauna	bone		BRNHS	KB	29-Sep-15		3-9	8.8	inside SW unit 1 - east; 1 m from s wall of building
1670	R	18	BB	1	2	1	vertebra	bird; medium	process	fauna	bone	unfused; lateral half of centrum and process	BRNHS	KB	29-Sep-15		0-3	0.2	inside SW unit 1 - east; 1 m from s wall of building
1670	R	18	BB	2	1	1	rib	bird; large	shaft; proximal	fauna	bone	proximal end and shaft	BRNHS	KB	29-Sep-15		0-3	0.5	SW inside
1670	R	18	BB	2	2	1	scapula	large ungulate	blade	fauna	bone		BRNHS	KB	29-Sep-15		3-9	2.1	SW inside
1670	R	18	CC	1	1	1	unidentified wire	tools and equipment, miscellaneous	incomplete	metal	ferrous	drawn	BRNHS	KB	29-Sep-15			10.7	bent; corroded; inside SE unit 1-east; 1 m from s wall of building
1670	R	18	CC	1	2	1	nail, common	round shank	head; shank	metal	ferrous	drawn	BRNHS	KB	29-Sep-15			0.5	round head; 1"; corroded; inside SE unit 1-east; 1 m from s wall of building
1670	R	18	CC	1	3	1	long bone	large ungulate	shaft	fauna	bone		BRNHS	KB	29-Sep-15		0-3	6	inside SE unit 1-east; 1 m from s wall of building

Bar U Ranch AIA for Proposed New Workshop

2015-WL-19919

Site 1670R; Operation 18

Site No.	Code	Op	Sub Op	Lot	Inv #	Qty	Object Name	Object Description	Portion	Material	Material Desc.	Mft marks/ décor.	Park Code	Collector	Date Collected	Depth	Size (cm)	Wgt (gm)	Remarks
1670	R	18	CC	1	4	5	long bone	large ungulate	shaft	fauna	bone		BRNHS	KB	29-Sep-15		0-3	5.1	inside SE unit 1-east; 1 m from s wall of building
1670	R	18	CC	2	1	3	scapula	large ungulate	blade	fauna	bone		BRNHS	KB	29-Sep-15		3-9	6.1	inside SE
1670	R	18	CC	2	2	5	rib	large ungulate	shaft	fauna	bone		BRNHS	KB	29-Sep-15		0-3	3.5	inside SE
1670	R	18	CC	3	1	1	long bone	large ungulate	shaft	fauna	bone		BRNHS	DB/KB	29-Sep-15		3-9	3.5	SE quad; 1m from s wall
1670	R	18	CC	3	2	1	rib	large ungulate	shaft	fauna	bone		BRNHS	DB/KB	29-Sep-15		0-3	1.1	SE quad; 1m from s wall
1670	R	18	CC	3	3	1	unclassifiable	artifact remnant	scrap	indeterminate			BRNHS	DB/KB	29-Sep-15			0.4	unknown substance, appears to have gluey substance between two layers; SE quad; 1m from s wall
1670	R	18	DD	1	1	1	unidentified wire	tools and equipment, miscellaneous	incomplete	metal	ferrous	drawn	BRNHS	KB	29-Sep-15			10.3	bent; corroded; inside NW unit 1 east; 1.5 m from s wall of building
1670	R	18	DD	1	2	1	nail, common	round shank	head; shank	metal	ferrous	drawn	BRNHS	KB	29-Sep-15			7.2	round head; bent; corroded; inside NW unit 1 east; 1.5 m from s wall of building
1670	R	18	DD	1	3	1	bolt	countersunk	head; shank	metal	ferrous	cast	BRNHS	KB	29-Sep-15			24.6	countersunk; corroded; inside NW unit 1 east; 1.5 m from s wall of building
1670	R	18	DD	1	4	1	nut	hexagonal	complete	metal	ferrous	cast	BRNHS	KB	29-Sep-15			40.6	large nut 3/4" tall; bore diameter approx 1/2", threaded; inside NW unit 1 east; 1.5 m from s wall of building
1670	R	18	DD	1	5	1	bolt	square head; threaded	head; shank	metal	ferrous	cast	BRNHS	KB	29-Sep-15			229.89	large square head bolt, with threading only at extreme end; approx 5 1/2" long, shaft diameter 1/2"; corroded; inside NW unit 1 east; 1.5m from s wall of building
1670	R	18	DD	1	6	3	wood, finished	building fragment	incomplete	miscellaneous organic	wood	milled	BRNHS	KB	29-Sep-15			7.1	milled wood, visible saw marks; inside NW unit 1 east; 1.5 m from s wall of building
1670	R	18	DD	1	7	4	long bone	large ungulate	shaft	fauna	bone		BRNHS	KB	29-Sep-15			7.2	inside NW unit 1 east; 1.5 m from s wall of building
1670	R	18	DD	1	8	1	unclassifiable	artifact remnant	scrap	indeterminate			BRNHS	KB	29-Sep-15			0.5	unknown substance, appears to have gluey substance between two layers; inside NW unit 1 east; 1.5 m from s wall of building
1670	R	18	DD	1	9	1	unidentified wire	tools and equipment, miscellaneous	incomplete	metal	ferrous	drawn	BRNHS	KB	29-Sep-15			0.3	thin wire bent into circle, part of spring?; corroded; inside NW unit 1 east; 1.5 m from s wall of building
1670	R	18	DD	2	1	1	unidentifiable fragment	large ungulate	scrap	fauna	bone		BRNHS	KB/DB	29-Sep-15		0-3	0.3	NW inside
1670	R	18	EE	1	1	1	nut	hexagonal	incomplete	metal	ferrous	cast	BRNHS	KB	29-Sep-15			8.1	broken, corroded; inside NE quad, unit 1- east; 1.5 m from s wall of building

Bar U Ranch AIA for Proposed New Workshop

2015-WL-19919

Site 1670R; Operation 18

Site No.	Code	Op	Sub Op	Lot	Inv #	Qty	Object Name	Object Description	Portion	Material	Material Desc.	Mft marks/ décor.	Park Code	Collector	Date Collected	Depth	Size (cm)	Wgt (gm)	Remarks
1670	R	18	EE	1	2	1	cotter pin	mechanized transportation and machinery; non-automotive machine parts	complete	metal	ferrous	cast	BRNHS	KB	29-Sep-15			3.1	complete; inside NE quad, unit 1- east; 1.5 m from s wall of building
1670	R	18	EE	1	3	1	washer	round	complete	metal	ferrous	cast	BRNHS	KB	29-Sep-15			1.1	inside NE quad, unit 1- east; 1.5 m from s wall of building
1670	R	18	EE	1	4	2	nail, common	round shank	head; shank	metal	ferrous	drawn	BRNHS	KB	29-Sep-15			14	round head; 3"; corroded; ; inside NE quad, unit 1- east; 1.5 m from s wall of building
1670	R	18	EE	1	5	1	long bone	large ungulate	shaft	fauna	bone		BRNHS	KB	29-Sep-15		3-9	3.2	inside NE quad, unit 1- east; 1.5 m from s wall of building
1670	R	18	EE	1	6	1	unclassifiable	artifact remnant	scrap	indeterminate	leather		BRNHS	KB	29-Sep-15			0.01	could this be leather? Seems to be shaped into a rounded corner; ; inside NE quad, unit 1- east; 1.5 m from s wall of building
1670	R	18	EE	1	7	1	unidentified	unidentified	incomplete	miscellaneous inorganic	plastic	yellow; black	BRNHS	KB	29-Sep-15			1.2	yellow plastic handle with hinged black plastic piece, broken; inside NE quad, unit 1- east; 1.5 m from s wall of building
1670	R	18	EE	1	8	1	unidentifiable	not identified	not identified				BRNHS	KB	29-Sep-15			1.1	inside NE quad, unit 1- east; 1.5 m from s wall of building
1670	R	18	EE	2	1	2	scapula	large ungulate	blade	fauna	bone		BRNHS	KB/DB	29-Sep-15		3-9	11.2	NE inside
1670	R	18	EE	2	2	2	unidentifiable fragment	large ungulate	scrap	fauna	bone		BRNHS	KB	29-Sep-15		0-3	1	NE inside
1670	R	18	EE	2	3	1	unidentifiable fragment	not identified	not identified	glass	aqua	moulded	BRNHS	KB	29-Sep-15			0.5	NE inside
1670	R	18	FF	1	1	1	nail, common	round shank	head; shank	metal	ferrous	drawn	BRNHS	KB/DB	29-Sep-15			3	round head, 2 1/2"; corroded; sw quad, unit 2; 2.0 m from s wall of building
1670	R	18	FF	1	2	1	foil	unclassified container/package	incomplete	metal	grey	machine made	BRNHS	KB/DB	29-Sep-15			0	small piece of foil, crumpled; sw quad, unit 2; 2.0 m from s wall of building
1670	R	18	FF	1	3	2	long bone	large ungulate	shaft	fauna	bone		BRNHS	KB/DB	29-Sep-15		3-9	9.5	sw quad, unit 2; 2.0 m from s wall of building
1670	R	18	FF	1	4	1	unidentifiable fragment	large ungulate	scrap	fauna	bone		BRNHS	KB/DB	29-Sep-15		0-3	1.2	sw quad, unit 2; 2.0 m from s wall of building
1670	R	18	FF	1	5	1	unclassifiable	artifact remnant	scrap	indeterminate			BRNHS	KB/DB	29-Sep-15			0.5	unknown substance, appears to have gluey substance between two layers; inside NW unit 1 east; 1.5 m from s wall of building
1670	R	18	FF	2	1	2	long bone	large ungulate	shaft	fauna	bone	charred?; weathered	BRNHS	KB/DB	29-Sep-15		3-9	9.4	SW quad, unit 2 inside
1670	R	18	FF	2	2	1	unidentifiable fragment	large ungulate	scrap	fauna	bone		BRNHS	KB/DB	29-Sep-15		0-3	0.4	SW quad, unit 2 inside
1670	R	18	FF	3	1	1	long bone	large ungulate	shaft	fauna	bone		BRNHS	KB/DB	29-Sep-15		0-3	4.3	SW quad, unit 2 inside

Bar U Ranch AIA for Proposed New Workshop

2015-WL-19919

Site 1670R; Operation 18

Site No.	Code	Op	Sub Op	Lot	Inv #	Qty	Object Name	Object Description	Portion	Material	Material Desc.	Mft marks/ décor.	Park Code	Collector	Date Collected	Depth	Size (cm)	Wgt (gm)	Remarks
1670	R	18	FF	3	2	1	unidentifiable fragment	mammal	scrap	fauna	bone	looks like bone flake	BRNHS	KB/DB	29-Sep-15		0-3	0.3	SW quad, unit 2 inside
1670	R	18	GG	1	1	1	unidentified wire	tools and equipment, miscellaneous	incomplete	metal	ferrous	drawn	BRNHS	KB/DB	29-Sep-15			13.6	bent; corroded; SE quad unit 2, 2.0 m from s building wall
1670	R	18	GG	1	2	1	nut	square	complete	metal	ferrous	cast	BRNHS	KB/DB	29-Sep-15			7.8	square threaded nut. Corroded; SE quad unit 2, 2.0 m from s building wall
1670	R	18	GG	1	3	2	rib	large ungulate	shaft	fauna	bone		BRNHS	KB/DB	29-Sep-15		0-3	2.5	SE quad unit 2, 2.0 m from s building wall
1670	R	18	GG	1	4	1	long bone	large ungulate	shaft	fauna	bone		BRNHS	KB/DB	29-Sep-15		3-9	1.7	SE quad unit 2, 2.0 m from s building wall
1670	R	18	GG	1	5	1	long bone	mammal; medium	shaft	fauna	bone	tubular shaft fragment; very juvenile due to bone porosity, possibly pig	BRNHS	KB/DB	29-Sep-15		0-3	1.1	SE quad unit 2, 2.0 m from s building wall
1670	R	18	GG	1	6	1	clinker	tools and equipment; miscellaneous	incomplete	metal	composite		BRNHS	KB/DB	29-Sep-15			0.4	clinker-y material; SE quad unit 2, 2.0 m from s building wall
1670	R	18	GG	1	7	3	unclassifiable	artifact remnant	scrap	indeterminate			BRNHS	KB/DB	29-Sep-15			1.3	unknown substance, appears to have gluey substance between two layers; SE quad unit 2, 2.0 m from s building wall
1670	R	18	GG	2	1	1	long bone	large ungulate	shaft	fauna	bone		BRNHS	KB/DB	29-Sep-15		3-9	6.5	SE quad, unit 2 inside
1670	R	18	GG	2	2	1	unidentifiable fragment	large ungulate	scrap	fauna	bone		BRNHS	KB/DB	29-Sep-15		0-3	0.5	SE quad, unit 2 inside
1670	R	18	GG	2	3	1	nail, common	round shank	shank	metal	ferrous	drawn	BRNHS	KB/DB	29-Sep-15			0.6	small nail, shank only; corroded; SE quad, unit 2 inside
1670	R	18	GG	3	1	1	long bone	large ungulate	shaft	fauna	bone		BRNHS	KB/DB	29-Sep-15		3-9	2.6	SE quad, unit 2, inside
1670	R	18	HH	1	1	1	unidentified wire	tools and equipment, miscellaneous	incomplete	metal	ferrous	drawn	BRNHS	KB/DB	29-Sep-15			5.1	length of wire with one end bent into lip; corroded; NW quad, 2.5 m from s wall of building
1670	R	18	HH	1	2	1	bolt	eye	complete	metal	ferrous	cast	BRNHS	KB/DB	29-Sep-15			30.4	with hexagonal nut on end; corroded; NW quad, 2.5 m from s wall of building
1670	R	18	HH	1	3	1	spring	mechanized transportation and machinery; non-mechanized transport	incomplete	metal	ferrous	drawn	BRNHS	KB/DB	29-Sep-15			2.2	portion of a spring; NW quad, 2.5 m from s wall of building
1670	R	18	HH	1	4	1	nail, common	round shank	complete	metal	ferrous	drawn	BRNHS	KB/DB	29-Sep-15			0.5	round head, 1"; corroded; NW quad, 2.5 m from s wall of building
1670	R	18	HH	1	5	2	long bone	large ungulate	scrap	fauna	bone		BRNHS	KB/DB	29-Sep-15		0-3	1.4	NW quad, 2.5 m from s wall of building

Bar U Ranch AIA for Proposed New Workshop

2015-WL-19919

Site 1670R; Operation 18

Site No.	Code	Op	Sub Op	Lot	Inv #	Qty	Object Name	Object Description	Portion	Material	Material Desc.	Mft marks/ décor.	Park Code	Collector	Date Collected	Depth	Size (cm)	Wgt (gm)	Remarks
1670	R	18	HH	1	6	1	cranial	large ungulate	scrap	fauna	bone	calcined	BRNHS	KB/DB	29-Sep-15		0-3	0.4	NW quad, 2.5 m from s wall of building
1670	R	18	HH	1	7	1	clinker	tools and equipment; miscellaneous	incomplete	metal	composite		BRNHS	KB/DB	29-Sep-15			2.7	NW quad, 2.5 m from s wall of building
1670	R	18	HH	1	8	1	unidentifiable	not identified	not identified				BRNHS	KB/DB	29-Sep-15			1.4	NW quad, 2.5 m from s wall of building
1670	R	18	HH	2	1	2	long bone	large ungulate	scrap	fauna	bone		BRNHS	KB/DB	29-Sep-15		0-3	2.4	NW quad inside
1670	R	18	JJ	1	1	1	bolt	countersunk	head; shank	metal	ferrous	cast	BRNHS	KB/DB	29-Sep-15			10.3	countersunk; slot head; threading missing; corroded; NE quad, unit 2, 2.5 m from s wall of building
1670	R	18	JJ	1	2	2	nail, common	round shank	complete	metal	ferrous	drawn	BRNHS	KB/DB	29-Sep-15			1	round head; 1", corroded; NE quad, unit 2, 2.5 m from s wall of building
1670	R	18	JJ	1	3	1	unidentifiable	indeterminate	fragment	fauna	leather	tanned; cut	BRNHS	KB/DB	29-Sep-15			3.5	roughly cut piece of leather with crude hole cut out of centre; NE quad, unit 2, 2.5 m from s wall of building
1670	R	18	JJ	1	4	2	mortar	building fragment	incomplete	lithic	plaster/mortar		BRNHS	KB/DB	29-Sep-15			5.9	NE quad, unit 2, 2.5 m from s wall of building
1670	R	18	JJ	1	5	1	rib	large ungulate	shaft	fauna	bone		BRNHS	KB/DB	29-Sep-15		3-6	3.1	NE quad, unit 2, 2.5 m from s wall of building
1670	R	18	JJ	1	6	1	rib	large ungulate	shaft	fauna	bone		BRNHS	KB/DB	29-Sep-15		0-3	1.4	NE quad, unit 2, 2.5 m from s wall of building
1670	R	18	JJ	2	1	1	long bone	large ungulate	shaft	fauna	bone	charred	BRNHS	KB/DB	29-Sep-15		0-3	3.4	NE quad, inside
1670	R	18	JJ	2	2	3	long bone	large ungulate	shaft	fauna	bone		BRNHS	KB/DB	29-Sep-15		0-3	7.1	NE quad, inside
1670	R	18	JJ	2	3	1	unidentifiable fragment	large ungulate	scrap	fauna	bone		BRNHS	KB/DB	29-Sep-15		0-.3	0.6	NE quad, inside
1670	R	18	JJ	2	4	1	flake, utilized	marginal retouch	medial	worked lithic	chalcedony; brown	marginal retouch on both lateral edges; midsection of flake	BRNHS	KB/DB	29-Sep-15		0.66-2.5	0.2	NE quad, inside
1670	R	18	KK	1	1	1	cotter pin	mechanized transportation and machinery; non-automotive machine parts	complete	metal	ferrous	cast	BRNHS	KB/DB	30-Sep-15			4.6	complete
1670	R	18	KK	1	2	2	nail, common	round shank	complete	metal	ferrous	drawn	BRNHS	KB/DB	30-Sep-15			1	round head, 1 1/4"; corroded
1670	R	18	KK	1	3	1	nail, common	round shank	complete	metal	ferrous	drawn	BRNHS	KB/DB	30-Sep-15			0.5	round head; bent; corroded
1670	R	18	KK	1	4	1	nail, common	round shank	complete	metal	ferrous	drawn	BRNHS	KB/DB	30-Sep-15			2.9	round head; bent; corroded
1670	R	18	KK	1	5	1	nail, common	round shank	complete	metal	ferrous	drawn	BRNHS	KB/DB	30-Sep-15			6.8	round head; 3 1/4"; corroded
1670	R	18	KK	1	6	1	bottle	indeterminate	not identified	glass	amber/brown	moulded	BRNHS	KB/DB	30-Sep-15			0.8	likely bottle glass, small sherd
1670	R	18	KK	1	7	3	long bone	large ungulate	shaft	fauna	bone		BRNHS	KB/DB	30-Sep-15		3-9	17.3	
1670	R	18	LL	1	1	1	unidentified wire	tools and equipment, miscellaneous	incomplete	metal	ferrous	drawn	BRNHS	KB/DB	30-Sep-15			6.2	bent; corroded
1670	R	18	LL	1	2	2	nail, common	round shank	complete	metal	ferrous	drawn	BRNHS	KB/DB	30-Sep-15			0.9	round head; 1 1/4", corroded
1670	R	18	LL	1	3	1	nail, common	round shank	complete	metal	ferrous	drawn	BRNHS	KB/DB	30-Sep-15			3.5	round head; 2 1/2", corroded

Bar U Ranch AIA for Proposed New Workshop

2015-WL-19919

Site 1670R; Operation 18

Site No.	Code	Op	Sub Op	Lot	Inv #	Qty	Object Name	Object Description	Portion	Material	Material Desc.	Mft marks/ décor.	Park Code	Collector	Date Collected	Depth	Size (cm)	Wgt (gm)	Remarks
1670	R	18	LL	1	4	1	nail, common	round shank	complete	metal	ferrous	drawn	BRNHS	KB/DB	30-Sep-15			6.9	round head; 3", corroded
1670	R	18	LL	1	5	2	unidentified metal fragment	tools and equipment; miscellaneous	incomplete	metal	ferrous		BRNHS	KB/DB	30-Sep-15			9.1	strapping, folded at one end; bent; corroded
1670	R	18	LL	1	6	4	function unknown	function unknown	incomplete	not identified	not identified		BRNHS	KB/DB	30-Sep-15			1.6	unknown materials
1670	R	18	LL	2	1	1	rib	large ungulate	shaft	fauna	bone		BRNHS	KB/DB	30-Sep-15		3-9	0.5	
1670	R	18	MM	1	1	1	bolt; nut; washers	hexagonal head; threaded	head; shank	metal	ferrous	cast	BRNHS	KB/DB	30-Sep-15			299	hexagonal head; 5" bolt with two washers and hexagonal nut; corroded
1670	R	18	MM	1	2	2	unidentified wire	tools and equipment; miscellaneous	incomplete	metal	ferrous	drawn	BRNHS	KB/DB	30-Sep-15			3	bent; corroded
1670	R	18	MM	1	3	1	nail, common	round shank	complete	metal	ferrous	drawn	BRNHS	KB/DB	30-Sep-15			4.6	round head; bent; corroded
1670	R	18	MM	1	4	1	foil	unclassified container/package	incomplete	metal	grey	machine made	BRNHS	KB/DB	30-Sep-15			0.1	crumpled foil
1670	R	18	MM	1	5	1	unidentifiable fragment	not identified	not identified	glass	manganese ting?	moulded	BRNHS	KB/DB	30-Sep-15			1	small glass sherd; manganese
1670	R	18	MM	1	6	1	function unknown	function unknown	incomplete	not identified	miscellaneous inorganic?	tan; beige	BRNHS	KB/DB	30-Sep-15			4.9	tan exterior; beige interior; curved; surface cracked; exterior pebbly (finish or wear?); looks like a piece of stoneware crockery; white smooth interior, feels like plastic, exterior colour in a visible applied layer.
1670	R	18	MM	1	7	1	function unknown	function unknown	incomplete	not identified	not identified	black	BRNHS	KB/DB	30-Sep-15			0.9	unknown material; black and shiny on one side, perhaps tar?
1670	R	18	MM	1	8	1	long bone	large ungulate	shaft	fauna	bone		BRNHS	KB/DB	30-Sep-15			4.8	
1670	R	18	MM	1	9	1	cranial	large ungulate	incomplete	fauna	bone		BRNHS	KB/DB	30-Sep-15			0.2	
1670	R	18	MM	1	10	1	tooth	small ungulate	complete	fauna	tooth	worn, maxillary premolar	BRNHS	KB/DB	30-Sep-15			0.6	small ungulate, possibly sheep/goat?
1670	R	18	MM	2	1	2	long bone	large ungulate	shaft	fauna	bone		BRNHS	KB/DB	30-Sep-15		3-9	3.6	
1670	R	18	MM	2	2	2	unidentifiable fragment	large ungulate	scrap	fauna	bone		BRNHS	KB/DB	30-Sep-15		3-9	1.2	
1670	R	18	MM	2	3	1	mandible	rodent	incomplete	fauna	bone	incisor, symphysis; tooth row	BRNHS	KB/DB	30-Sep-15		0-3	0.3	ascending ramus broken away
1670	R	18	NN	1	1	1	nut	square, threaded	complete	metal	ferrous	cast	BRNHS	KB/DB	30-Sep-15			10.3	square; 5/8" wide; corroded; threaded
1670	R	18	NN	1	2	1	washer	round	complete	metal	ferrous	cast	BRNHS	KB/DB	30-Sep-15			10.5	1 1/4" exterior diameter; corroded
1670	R	18	NN	1	3	1	fencing staple	U-shaped	complete	metal	ferrous	machine	BRNHS	KB/DB	30-Sep-15			5.3	corroded
1670	R	18	NN	1	1	1	nail, common	round shank	complete	metal	ferrous	drawn	BRNHS	KB/DB	30-Sep-15			0.5	round head 1", corroded
1670	R	18	NN	1	4	1	nail, common	round shank	complete	metal	ferrous	drawn	BRNHS	KB/DB	30-Sep-15			6.5	round head; 3"; corroded
1670	R	18	NN	1	6	1	long bone	large ungulate	shaft	fauna	bone		BRNHS	KB/DB	30-Sep-15		3-9	1.9	
1670	R	18	NN	2	1	1	long bone	large ungulate	shaft	fauna	bone		BRNHS	KB/DB	30-Sep-15		3-9	3.3	
1670	R	18	NN	3	1	1	long bone	large ungulate	shaft	fauna	bone		BRNHS	KB/DB	30-Sep-15		3-9	2.2	
1670	R	18	PP	1	1	1	coin	tools and equipment; miscellaneous	complete	metal	grey	minted	BRNHS	KB/DB	30-Sep-15			2.3	1919 ten cent piece; Canada; King George V on reverse.
1670	R	18	PP	1	2	1	nail, common	round shank	complete	metal	ferrous	drawn	BRNHS	KB/DB	30-Sep-15			6.8	round head; 3" corroded

Bar U Ranch AIA for Proposed New Workshop

2015-WL-19919

Site 1670R; Operation 18

Site No.	Code	Op	Sub Op	Lot	Inv #	Qty	Object Name	Object Description	Portion	Material	Material Desc.	Mft marks/ décor.	Park Code	Collector	Date Collected	Depth	Size (cm)	Wgt (gm)	Remarks
1670	R	18	PP	1	3	1	nail, common	round shank	head; shank	metal	ferrous	drawn	BRNHS	KB/DB	30-Sep-15			5	round head; corroded
1670	R	18	PP	1	4	3	pane, window	window	incomplete	glass	colourless	rolled	BRNHS	KB/DB	30-Sep-15			1.3	cracked; appears to be flat glass - windowpane
1670	R	18	PP	1	5	1	long bone	large ungulate	shaft	fauna	bone		BRNHS	KB/DB	30-Sep-15		3-9	8.8	
1670	R	18	PP	1	6	1	costal cartilage	large ungulate	incomplete	fauna	bone		BRNHS	KB/DB	30-Sep-15		0-3	1.7	
1670	R	18	PP	1	7	1	cranial	mammal; medium/small	incomplete	fauna	bone	typmanic bulla?	BRNHS	KB/DB	30-Sep-15		0-3	0.1	
1670	R	18	QQ	1	1	1	barb	tools and equipment; miscellaneous	complete	metal	ferrous	drawn	BRNHS	KB/DB	30-Sep-15			4.5	barb from barbed wire fence; corroded
1670	R	18	QQ	1	2	1	cotter pin	mechanized transportation and machinery; non- automotive machine parts	incomplete	metal	ferrous	cast	BRNHS	KB/DB	30-Sep-15			4.5	cotter pin with one arm broken off
1670	R	18	QQ	1	3	1	nail, common	round shank	complete	metal	ferrous	drawn	BRNHS	KB/DB	30-Sep-15			6.3	finishing nail; bent; corroded
1670	R	18	QQ	1	4	1	nail, common	round shank	complete	metal	ferrous	drawn	BRNHS	KB/DB	30-Sep-15			3.4	round head 2 1/2"; corroded
1670	R	18	QQ	1	5	1	nut	square, threaded	complete	metal	ferrous	cast	BRNHS	KB/DB	30-Sep-15			11.8	5/8" wide; , threaded; one surface lightly beveled; corroded
1670	R	18	QQ	1	6	1	washer	round	complete	metal	ferrous	cast	BRNHS	KB/DB	30-Sep-15			0.9	approximately 3/4" outside diameter; bent; corroded
1670	R	18	QQ	1	7	1	unidentified	hardware?	complete	metal	ferrous	cast?	BRNHS	KB/DB	30-Sep-15			31.5	rectangular piece of metal, tapering at one end;; tang on narrower end; hole on wider end; beveled with file-like incisions along bevel
1670	R	18	QQ	1	8	2	bottle	indeterminate	not identified	glass	amber/brown	moulded	BRNHS	KB/DB	30-Sep-15			7.6	likely bottle glass, small sherd
1670	R	18	QQ	2	1	1	vertebra	small ungulate	incomplete	fauna	bone		BRNHS	KB/DB	30-Sep-15		3-9	2.7	
1670	R	18	QQ	2	2	1	rib	large ungulate	shaft	fauna	bone		BRNHS	KB/DB	30-Sep-15		3-9	0.9	
1670	R	18	RR	1	1	1	fencing staple	U-shaped	complete	metal	ferrous	machine	BRNHS	KB/DB	30-Sep-15			7.3	corroded
1670	R	18	RR	1	2	1	unidentified wire	tools and equipment, miscellaneous	incomplete	metal	ferrous	drawn	BRNHS	KB/DB	30-Sep-15			4.2	bent; corroded
1670	R	18	RR	1	3	1	bolt	carriage	head; shank	metal	ferrous	cast	BRNHS	KB/DB	30-Sep-15			19.3	corroded
1670	R	18	RR	1	4	1	vertebra	small ungulate	incomplete	fauna	bone		BRNHS	KB/DB	30-Sep-15		0-3	1.4	
1670	R	18	RR	1	5	1	long bone	large ungulate	shaft	fauna	bone		BRNHS	KB/DB	30-Sep-15		3-9	3.1	
1670	R	18	RR	1	6	1	unidentifiable fragment	large ungulate	scrap	fauna	bone		BRNHS	KB/DB	30-Sep-15		0-3	0.7	
1670	R	18	SS	1	1	1	nut	square, threaded	complete	metal	ferrous	cast	BRNHS	KB/DB	30-Sep-15			11.9	5/8" wide; threaded; corroded
1670	R	18	SS	1	2	1	nail, common	round shank	complete	metal	ferrous	drawn	BRNHS	KB/DB	30-Sep-15			3.7	corroded
1670	R	18	SS	1	3	1	bottle	indeterminate	not identified	glass	colourless	moulded	BRNHS	KB/DB	30-Sep-15			0.3	thinner glass, possibly neck of smaller bottle
1670	R	18	SS	1	4	1	pane, window	window	incomplete	glass	colourless	rolled	BRNHS	KB/DB	30-Sep-15			0.9	cracked; appears to be flat glass - windowpane
1670	R	18	SS	1	5	1	long bone	large ungulate	shaft	fauna	bone		BRNHS	KB/DB	30-Sep-15		3-9	2.2	
1670	R	18	SS	1	6	2	rib	large ungulate	shaft	fauna	bone		BRNHS	KB/DB	30-Sep-15		0-3	1.5	
1670	R	18	SS	1	7	1	unidentifiable	not identified	not identified				BRNHS	KB/DB	30-Sep-15			4	
1670	R	18	SS	2	1	1	P-2	bos/bison	complete	fauna	bone		BRNHS	KB/DB	30-Sep-15		3-9	21.2	